

# TSUBAKI Bearing Roller Conveyor Chain

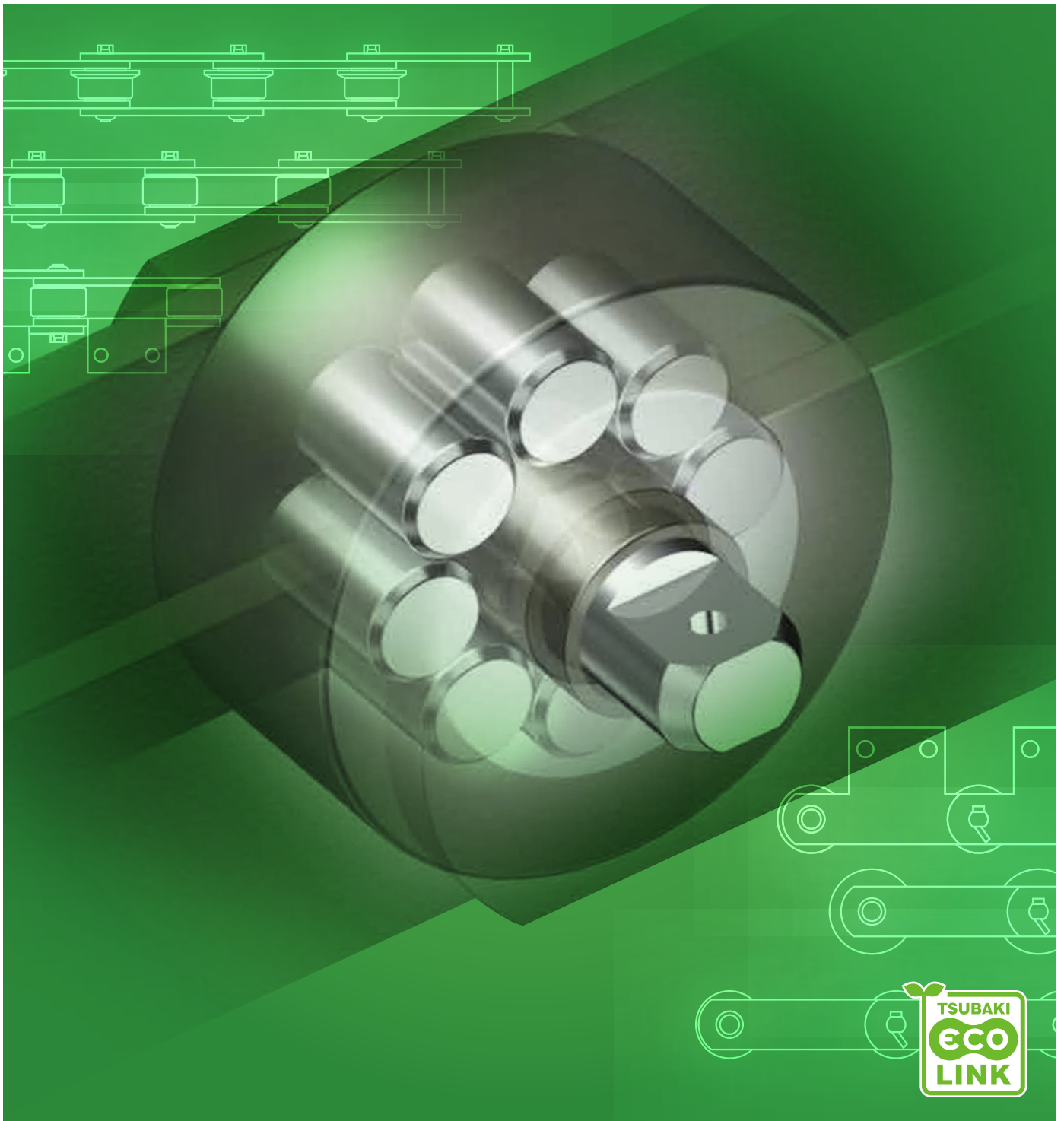

# CONTENTS

## Bearing Roller Conveyor Chain

---

|   |    |
|---|----|
| Features                                      | 03 |
| Application Examples                          | 05 |
| Sample Customizations                         | 06 |
| Standard Series                               | 07 |
| Anti-Dust Series                              | 09 |
| Lube-Free Series (Standard Specs)             | 11 |
| Lube-Free Series (Completely Lube-Free Specs) | 13 |
| Lube-Free Series (Water Resistant Specs)      | 15 |
| Attachment Dimensional Chart                  | 17 |
| List of Series                                | 19 |
| Q&A   | 20 |
| Notes on Use                                  | 21 |
| For Safe Use                                  | 22 |

# Bearing Roller Conveyor Chain

General Use

Dust Resistant

Lube Free

Completely Lube Free

Water Resistant

# Tough, Eco-Friendly—Tsubaki Bearing Roller Conveyor Chain

## Reduces Chain Running Resistance

Chain running resistance reduced by

Minimizes poor roller rotation and decreases rail wear

Cylindrical bearings ensure smooth roller rotation and reduce rail wear. Roller wear life is also dramatically increased.

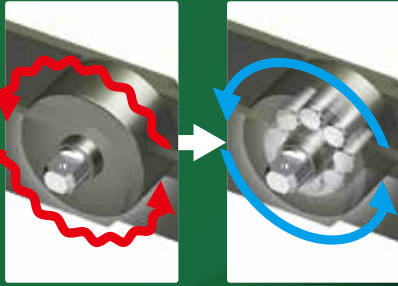

$\frac{1}{3}$

Cylindrical bearings

## Reduces Required Drive

Reduces motor capacity  $\frac{1}{2.5}$

Less power consumed means  $\frac{1}{3}$  less CO<sub>2</sub> emissions

Smaller motor means **30%** cost savings

Reduces chain replacement labor by  $\frac{1}{3}$



### With New Installations

Standard RF Conveyor Chain

Bearing Roller Conveyor Chain

Chain load

RF26250F **2 sizes down** RF12250BF

0.08 (When lubed) **1/3 the coefficient of friction** 0.03

31.4kN (3200kgf) **1/3 the chain load** 11.8kN (1200kgf)

13.5kW **1/2.5 the required kW** 5.1kW

Can help make your conveyor more compact and reduce energy costs

### When Replacing Existing Chain

Standard RF Conveyor Chain

Bearing Roller Conveyor Chain

Chain load

RF26250F **Same size** RF26250BF

0.08 (When lubed) **1/3 the coefficient of friction** 0.03

31.4kN (3200kgf) **1/3 the chain load** 11.8kN (1200kgf)

13.5kW **1/2.5 the required kW** 5.1kW

1 **3x the wear life** Over 3x

Offers superior chain service life, can help reduce conveyor maintenance labor and costs



# has a line-up of s to suit your needs.



Over **3X**  
the wear life

Note: Water resistant series has twice the wear life of RF Series

Chain load and required drive are only 1/3 of standard conveyor chains. This allows users to choose a smaller size chain, as well as reduce the size of their conveyor and necessary drive power, for greater cost savings.

## Longer Wear Life

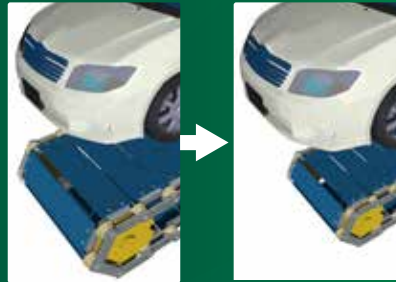

Better  
productivity

**Prevents stick-slip phenomenon at low speeds**  
Preventing stick-slip and providing smooth movement ensures stable conveyance and eliminates motion sickness on assembly lines for higher productivity.

## Stable Conveyance



## Selection

1. Refer to the Tsubaki Large Size Conveyor Chains & Sprockets catalog for selection.
2. Requirements for selection:
  - Roller rotation coefficient of friction See pg. 19.
  - Operating temperature range See pg. 19.
  - Sprocket  
All series/specifications can use sprockets for RF Conveyor Chains. See pg. 19 for sprocket number of teeth.
  - Roller allowable load  
Roller allowable load is the allowable load for one roller on a load-type conveyor. Roller allowable load assumes a guide rail tensile strength of 400N/m<sup>2</sup>(41kgf/m<sup>2</sup>). When using A attachments, compare attachment allowable loads and use the lower of the values.

## Sample Selection Conditions

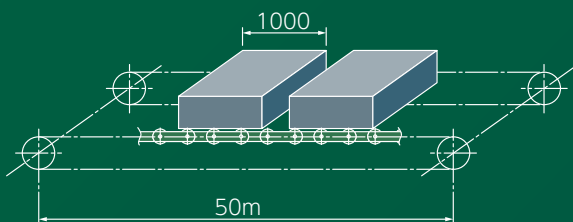

Equip. length: 50m  
 Speed: 10m/min  
 Chain pitch: 250  
 Conveyed items: 2000kgf/each x 40  
 No. of chain strands: 2  
 F rollers with A2 attachments selected

## Line-Up to Suit Any Application

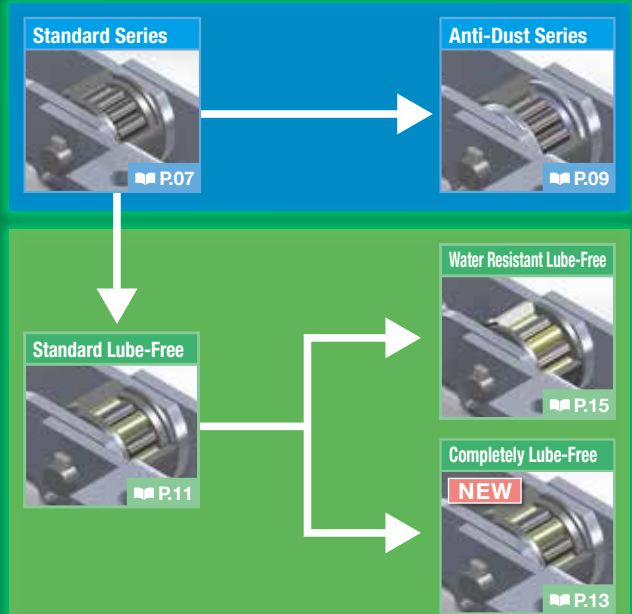

# Application Examples

## Standard Series

Completed vehicle conveyance



## Lube-Free Series

Web roll conveyance



## Anti-Dust Series

Casting conveyance  
(in contact with molding sand)



## Lube-Free Series

Coating line  
pallet conveyance



## Anti-Dust Series

Waste conveyance  
(scrap iron, rocks, etc.)



## Water Resistant Lube-Free Specs

Shower tester



# Sample Customizations

## Bearing Outboard Rollers

Easy roller replacement



## With Grease Nipples

Easy lubrication

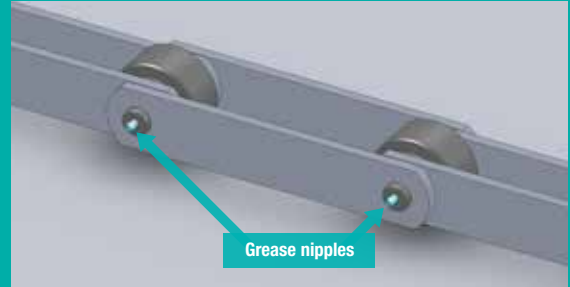

## BS Bearing Rollers

Same size as S Rollers on Standard Series

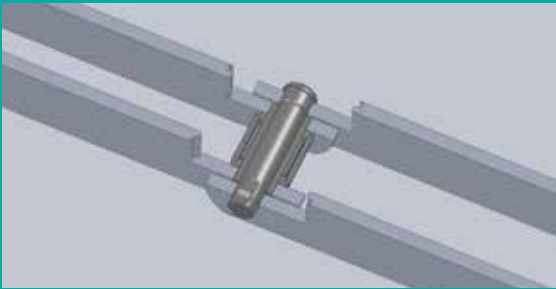

## Heat Resistant

Max. operating temp.: 150°C

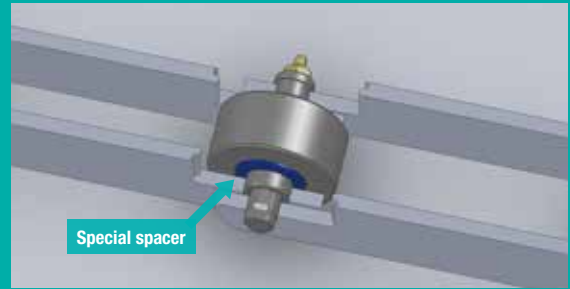

## Bearing Top Rollers

Reduces load during accumulation

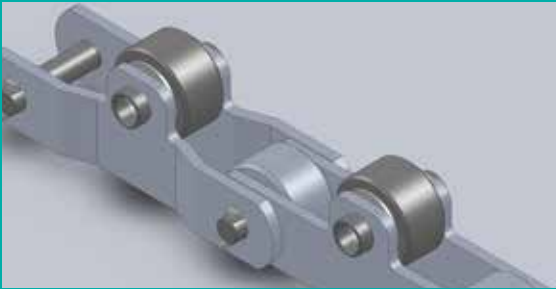

## Deep Link

Allows direct conveyance, even with BR rollers

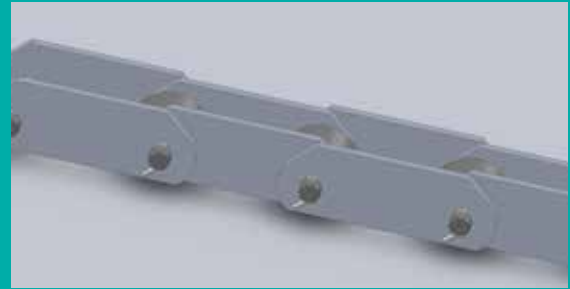

## With Ribbed Attachments

Higher attachment allowable load

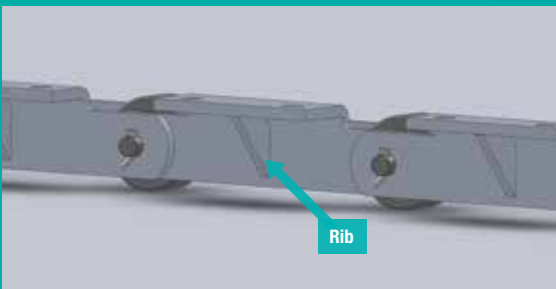

## Attachments with Nuts

Easy attachment

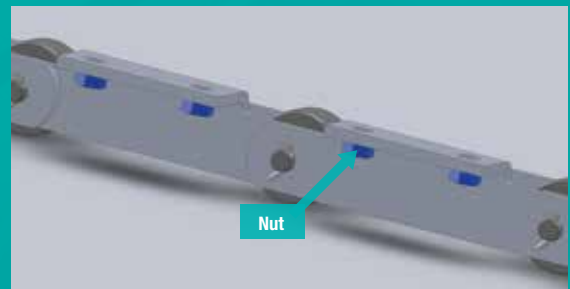



# Standard Series

Standard Series Bearing Roller Conveyor Chain features a unique construction of cylindrical bearings between rollers and bushes. (Patented) These rollers have the same dimensions as R and F Rollers on standard RF Conveyor Chain.

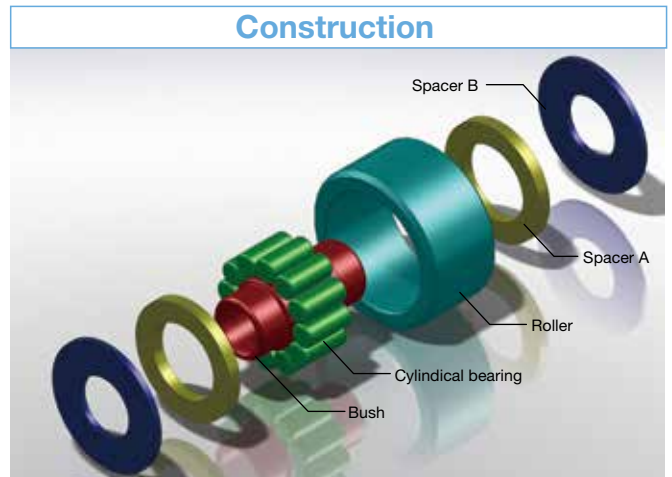
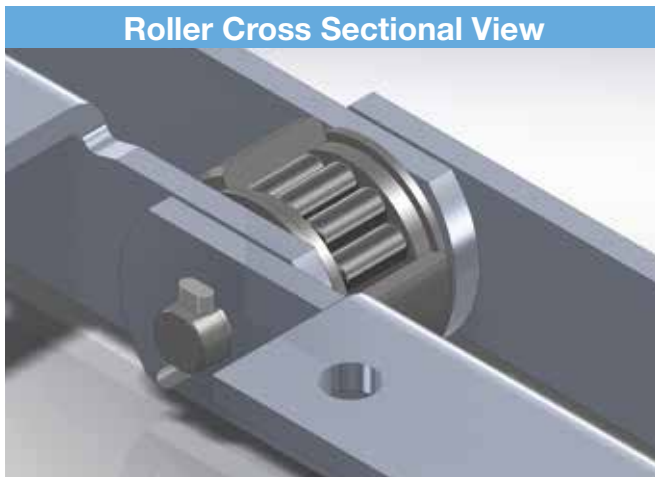

## Features

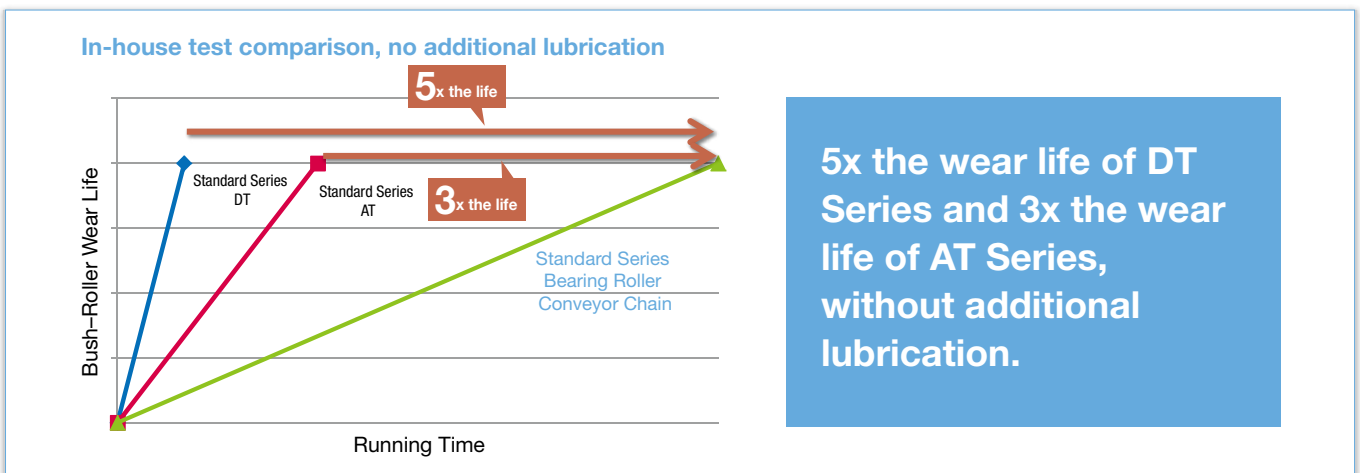

## Chain Numbering Example

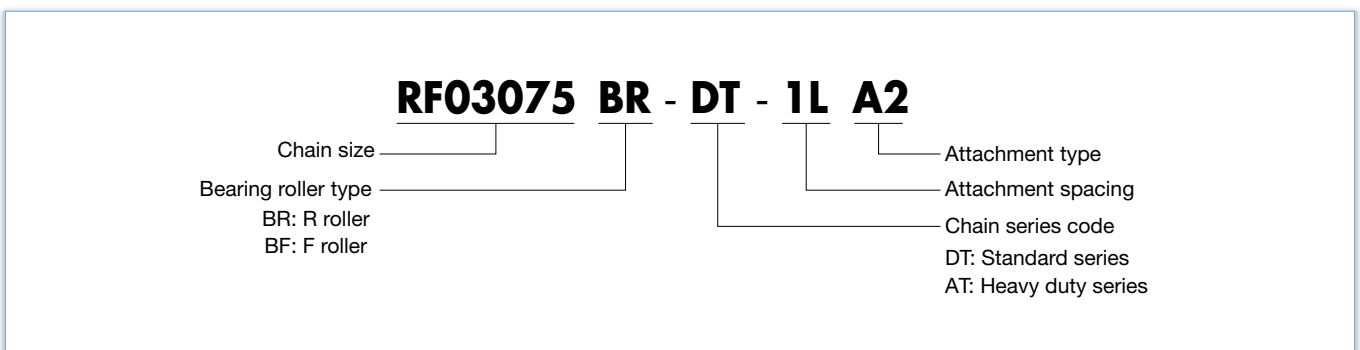



## BR Roller

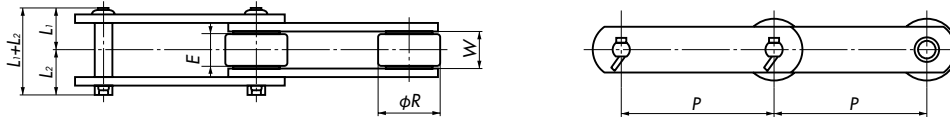

| Chain Size | Pitch<br><i>P</i> | Inner Link<br>Inner Width<br><i>W</i> | Pin   |                       |                       | R Roller             |                              | Roller<br>Allowable<br>Load<br>kN{kgf}/pc | Approx.<br>Mass<br>kg/m | Max. Allowable Load  |                      |
|------------|-------------------|---------------------------------------|---|-----------------------|-----------------------|----------------------|------------------------------|---|-------------------------|----------------------|----------------------|
|            |                   |                                       | <i>L</i> <sub>1</sub> + <i>L</i> <sub>2</sub> | <i>L</i> <sub>1</sub> | <i>L</i> <sub>2</sub> | Diameter<br><i>R</i> | Contact<br>Width<br><i>E</i> |   |                         | DT Series<br>kN{kgf} | AT Series<br>kN{kgf} |
| RF03075    | 75                | 16.1                                  | 38.0  | 18.0                  | 20.0                  | 31.8                 | 14.0                         | 1.96{200}                                 | 2.8                     | 4.20{430}            | 7.85{800}            |
| RF03100    | 100               |                                       |   |                       |                       |                      |                              |   |                         |                      |                      |
| RF05100    | 100               | 22.0                                  | 53.5  | 25.0                  | 28.5                  | 40.0                 | 19.0                         | 3.04{310}                                 | 5.2                     | 9.80{1000}           | 14.7{1500}           |
| RF05125    | 125               |                                       |   |                       |                       |                      |                              |   |                         |                      |                      |
| RF05150    | 150               | 27.0                                  | 65.5  | 31.0                  | 34.5                  | 44.5                 | 24.0                         | 4.12{420}                                 | 5.9                     | 11.2{1140}           | 14.7{1500}           |
| RF08125    | 125               |                                       |   |                       |                       |                      |                              |   |                         |                      |                      |
| RF08150    | 150               | 30.0                                  | 69.0  | 33.0                  | 36.0                  | 50.8                 | 26.0                         | 5.49{560}                                 | 10.0                    | 16.1{1650}           | 23.5{2400}           |
| RF10100    | 100               |                                       |   |                       |                       |                      |                              |   |                         |                      |                      |
| RF10125    | 125               | 37.1                                  | 83.5  | 40.5                  | 43.0                  | 65.0                 | 32.0                         | 8.34{850}                                 | 8.7                     | 26.6{2710}           | 36.3{3700}           |
| RF10150    | 150               |                                       |   |                       |                       |                      |                              |   |                         |                      |                      |
| RF12200    | 200               | 51.4                                  | 109.5   | 51.5                  | 58.0                  | 80.0                 | 44.0                         | 14.1{1440}                                | 20.0                    | 35.0{3570}           | 54.9{5600}           |
| RF12250    | 250               |                                       |   |                       |                       |                      |                              |   |                         |                      |                      |
| RF17200    | 200               | 57.2                                  | 116.5   | 55.5                  | 61.0                  | 100.0                | 50.0                         | 19.6{2000}                                | 17.0                    | 44.9{4570}           | 72.6{7400}           |
| RF17250    | 250               |                                       |   |                       |                       |                      |                              |   |                         |                      |                      |
| RF17300    | 300               | 66.7                                  | 146.0   | 68.0                  | 78.0                  | 125.0                | 56.0                         | 27.5{2800}                                | 16.0                    | 68.0{6930}           | 97.1{9900}           |
| RF26250    | 250               |                                       |   |                       |                       |                      |                              |   |                         |                      |                      |
| RF26300    | 300               | 66.7                                  | 146.0   | 68.0                  | 78.0                  | 125.0                | 56.0                         | 27.5{2800}                                | 26.0                    | 68.0{6930}           | 97.1{9900}           |
| RF26450    | 450               |                                       |   |                       |                       |                      |                              |   |                         |                      |                      |
| RF36300    | 300               | 66.7                                  | 146.0   | 68.0                  | 78.0                  | 125.0                | 56.0                         | 27.5{2800}                                | 40.0                    | 68.0{6930}           | 97.1{9900}           |
| RF36450    | 450               |                                       |   |                       |                       |                      |                              |   |                         |                      |                      |
| RF36600    | 600               |                                       |   |                       |                       |                      |                              |   | 28.0                    |                      |                      |

- Note: 1. Contact a Tsubaki representative for imperial sizes.  
 2. The above dimensions are nominal dimensions and may differ from actual dimensions.

## BF Roller

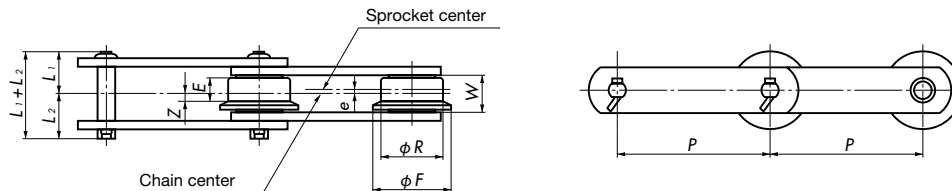

| Chain Size | Pitch<br><i>P</i> | Inner Link<br>Inner Width<br><i>W</i> | Pin   |                       |                       | F Roller             |                                |                              |                            |          | Roller<br>Allowable<br>Load<br>kN{kgf}/pc | Approx.<br>Mass<br>kg/m | Max. Allowable Load  |                      |
|------------|-------------------|---------------------------------------|---|-----------------------|-----------------------|----------------------|--------------------------------|------------------------------|----------------------------|----------|---|-------------------------|----------------------|----------------------|
|            |                   |                                       | <i>L</i> <sub>1</sub> + <i>L</i> <sub>2</sub> | <i>L</i> <sub>1</sub> | <i>L</i> <sub>2</sub> | Diameter<br><i>R</i> | Flange<br>Diameter<br><i>F</i> | Contact<br>Width<br><i>E</i> | Off-<br>Center<br><i>e</i> | <i>Z</i> |   |                         | DT Series<br>kN{kgf} | AT Series<br>kN{kgf} |
| RF03075    | 75                | 16.1                                  | 38.0  | 18.0                  | 20.0                  | 31.8                 | 42.0                           | 11.0                         | 1.5                        | 4.3      | 1.27{130}                                 | 2.9                     | 4.20{430}            | 7.85{800}            |
| RF03100    | 100               |                                       |   |                       |                       |                      |                                |                              |                            |          |   |                         |                      |                      |
| RF05100    | 100               | 22.0                                  | 53.5  | 25.0                  | 28.5                  | 40.0                 | 50.0                           | 14.0                         | 2.5                        | 4.5      | 1.96{200}                                 | 5.4                     | 9.80{1000}           | 14.7{1500}           |
| RF05125    | 125               |                                       |   |                       |                       |                      |                                |                              |                            |          |   |                         |                      |                      |
| RF05150    | 150               | 27.0                                  | 65.5  | 31.0                  | 34.5                  | 44.5                 | 55.0                           | 18.0                         | 2.5                        | 6.5      | 2.65{270}                                 | 6.2                     | 11.2{1140}           | 14.7{1500}           |
| RF08125    | 125               |                                       |   |                       |                       |                      |                                |                              |                            |          |   |                         |                      |                      |
| RF08150    | 150               | 30.0                                  | 69.0  | 33.0                  | 36.0                  | 50.8                 | 65.0                           | 20.0                         | 3.0                        | 7.0      | 3.43{350}                                 | 9.0                     | 16.1{1650}           | 23.5{2400}           |
| RF10125    | 125               |                                       |   |                       |                       |                      |                                |                              |                            |          |   |                         |                      |                      |
| RF10150    | 150               | 37.1                                  | 83.5  | 40.5                  | 43.0                  | 65.0                 | 80.0                           | 24.0                         | 4.0                        | 8.0      | 5.49{560}                                 | 12.1                    | 26.6{2710}           | 36.3{3700}           |
| RF12200    | 200               |                                       |   |                       |                       |                      |                                |                              |                            |          |   |                         |                      |                      |
| RF12250    | 250               | 51.4                                  | 109.5   | 51.5                  | 58.0                  | 80.0                 | 100.0                          | 34.0                         | 5.0                        | 12.0     | 9.81{1000}                                | 18.0                    | 35.0{3570}           | 54.9{5600}           |
| RF17200    | 200               |                                       |   |                       |                       |                      |                                |                              |                            |          |   |                         |                      |                      |
| RF17250    | 250               | 57.2                                  | 116.5   | 55.5                  | 61.0                  | 100.0                | 125.0                          | 38.0                         | 6.0                        | 13.0     | 13.7{1400}                                | 24.0                    | 44.9{4570}           | 72.6{7400}           |
| RF17300    | 300               |                                       |   |                       |                       |                      |                                |                              |                            |          |   |                         |                      |                      |
| RF26250    | 250               | 66.7                                  | 146.0   | 68.0                  | 78.0                  | 125.0                | 150.0                          | 42.0                         | 7.0                        | 14.0     | 18.6{1900}                                | 27.0                    | 68.0{6930}           | 97.1{9900}           |
| RF26300    | 300               |                                       |   |                       |                       |                      |                                |                              |                            |          |   |                         |                      |                      |
| RF26450    | 450               | 66.7                                  | 146.0   | 68.0                  | 78.0                  | 125.0                | 150.0                          | 42.0                         | 7.0                        | 14.0     | 18.6{1900}                                | 42.0                    | 68.0{6930}           | 97.1{9900}           |
| RF36300    | 300               |                                       |   |                       |                       |                      |                                |                              |                            |          |   |                         |                      |                      |
| RF36450    | 450               | 66.7                                  | 146.0   | 68.0                  | 78.0                  | 125.0                | 150.0                          | 42.0                         | 7.0                        | 14.0     | 18.6{1900}                                | 33.0                    | 68.0{6930}           | 97.1{9900}           |
| RF36600    | 600               |                                       |   |                       |                       |                      |                                |                              |                            |          |   |                         |                      |                      |
| RF36600    | 600               |                                       |   |                       |                       |                      |                                |                              |                            |          |   | 29.0                    |                      |                      |

- Note: 1. Contact a Tsubaki representative for imperial sizes.  
 2. The above dimensions are nominal dimensions and may differ from actual dimensions.

# Anti-Dust Series

Anti-Dust Series Bearing Roller Conveyor Chain uses a labyrinth construction and seal to make it harder for dust and debris to infiltrate compared to our Standard Series. (Patented)  
 These rollers have the same dimensions as R and F Rollers on standard RF Conveyor Chain.

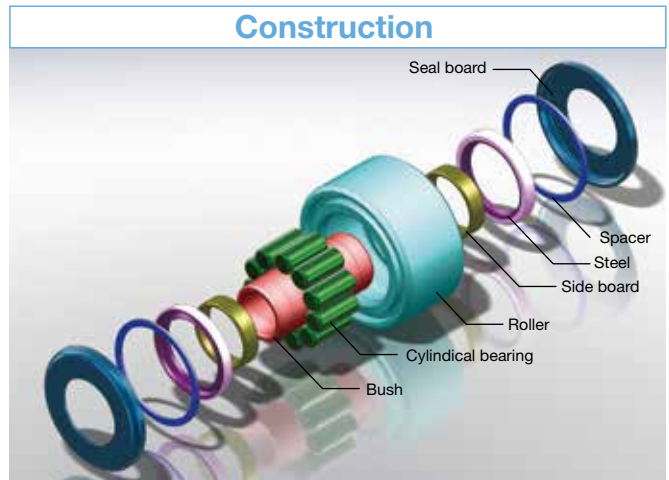
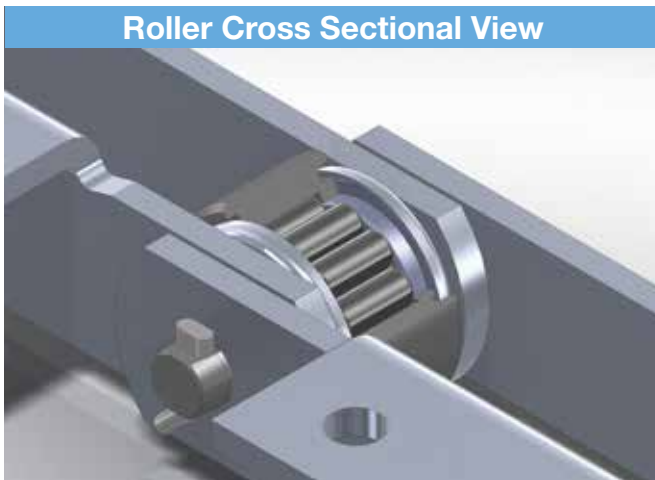

## Features

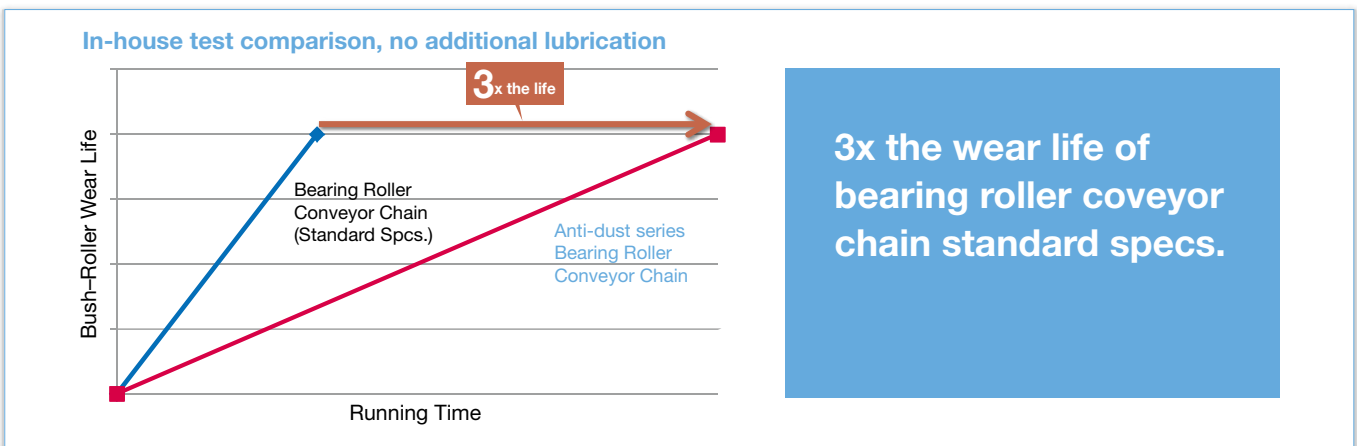

## Chain Numbering Example

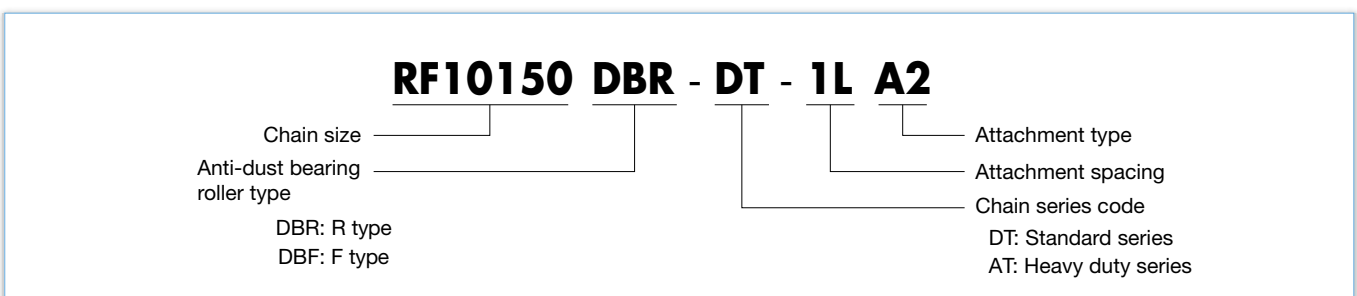

DBR Roller

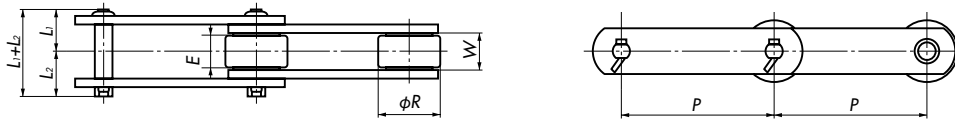

| Chain Size | Pitch<br><i>P</i> | Inner Link<br>Inner Width<br><i>W</i> | Pin   |                       |                       | R Roller             |                              | Roller<br>Allowable<br>Load<br>kN{kgf}/pc | Approx.<br>Mass<br>kg/m | Max. Allowable Load  |                      |
|------------|-------------------|---------------------------------------|---|-----------------------|-----------------------|----------------------|------------------------------|---|-------------------------|----------------------|----------------------|
|            |                   |                                       | <i>L</i> <sub>1</sub> + <i>L</i> <sub>2</sub> | <i>L</i> <sub>1</sub> | <i>L</i> <sub>2</sub> | Diameter<br><i>R</i> | Contact<br>Width<br><i>E</i> |   |                         | DT Series<br>kN{kgf} | AT Series<br>kN{kgf} |
| RF10100    | 100               |                                       |   |                       |                       |                      |                              | 10.0                                      |                         |                      |                      |
| RF10125    | 125               | 30.0                                  | 69.0  | 33.0                  | 36.0                  | 50.8                 | 26.0                         | 5.49{560}                                 | 8.7                     | 16.1{1650}           | 23.5{2400}           |
| RF10150    | 150               |                                       |   |                       |                       |                      |                              | 8.0                                       |                         |                      |                      |
| RF12200    | 200               |                                       |   |                       |                       |                      |                              | 11.6                                      |                         |                      |                      |
| RF12250    | 250               | 37.1                                  | 83.5  | 40.5                  | 43.0                  | 65.0                 | 32.0                         | 8.34{850}                                 | 10.4                    | 26.6{2710}           | 36.3{3700}           |
| RF17200    | 200               |                                       |   |                       |                       |                      |                              | 20.0                                      |                         |                      |                      |
| RF17250    | 250               | 51.4                                  | 109.5   | 51.5                  | 58.0                  | 80.0                 | 44.0                         | 14.1{1440}                                | 17.0                    | 35.0{3570}           | 54.9{5600}           |
| RF17300    | 300               |                                       |   |                       |                       |                      |                              | 16.0                                      |                         |                      |                      |
| RF26250    | 250               |                                       |   |                       |                       |                      |                              | 26.0                                      |                         |                      |                      |
| RF26300    | 300               | 57.2                                  | 116.5   | 55.5                  | 61.0                  | 100.0                | 50.0                         | 19.6{2000}                                | 23.0                    | 44.9{4570}           | 72.6{7400}           |
| RF26450    | 450               |                                       |   |                       |                       |                      |                              | 19.0                                      |                         |                      |                      |
| RF36300    | 300               |                                       |   |                       |                       |                      |                              | 40.0                                      |                         |                      |                      |
| RF36450    | 450               | 66.7                                  | 146.0   | 68.0                  | 78.0                  | 125.0                | 56.0                         | 27.5{2800}                                | 32.0                    | 68.0{6930}           | 97.1{9900}           |
| RF36600    | 600               |                                       |   |                       |                       |                      |                              | 28.0                                      |                         |                      |                      |

- Note: 1. Chain cannot be used for conveyance in environments where it will be fully covered in dust.  
 2. Periodically lubricate the base chain using the grease nipple on the pin head.  
 3. Base chain is compatible with General Use Conveyor Chains and can use current sprockets.  
 4. Do not use in corrosive environments. (Exposed to or submersed in water, etc.)  
 5. The above dimensions are nominal dimensions and may differ from actual dimensions.

DBF Roller

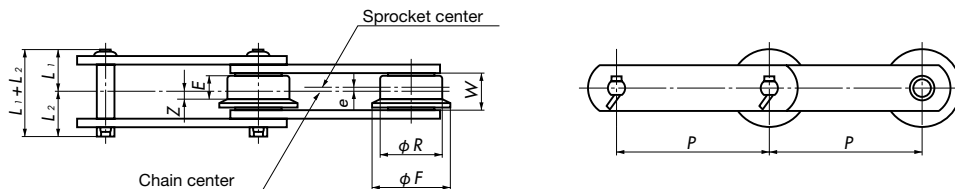

| Chain Size | Pitch<br><i>P</i> | Inner Link<br>Inner Width<br><i>W</i> | Pin   |                       |                       | F Roller             |                                |                              |                            |          | Roller<br>Allowable<br>Load<br>kN{kgf}/pc | Approx.<br>Mass<br>kg/m | Max. Allowable Load  |                      |
|------------|-------------------|---------------------------------------|---|-----------------------|-----------------------|----------------------|--------------------------------|------------------------------|----------------------------|----------|---|-------------------------|----------------------|----------------------|
|            |                   |                                       | <i>L</i> <sub>1</sub> + <i>L</i> <sub>2</sub> | <i>L</i> <sub>1</sub> | <i>L</i> <sub>2</sub> | Diameter<br><i>R</i> | Flange<br>Diameter<br><i>F</i> | Contact<br>Width<br><i>E</i> | Off-<br>Center<br><i>e</i> | <i>Z</i> |   |                         | DT Series<br>kN{kgf} | AT Series<br>kN{kgf} |
| RF10125    | 125               | 30.0                                  | 69.0  | 33.0                  | 36.0                  | 50.8                 | 65.0                           | 20.0                         | 3.0                        | 7.0      | 3.43{350}                                 | 9.0                     | 16.1{1650}           | 23.5{2400}           |
| RF10150    | 150               |                                       |   |                       |                       |                      |                                |                              |                            |          | 8.3                                       |                         |                      |                      |
| RF12200    | 200               |                                       |   |                       |                       |                      |                                |                              |                            |          | 12.1                                      |                         |                      |                      |
| RF12250    | 250               | 37.1                                  | 83.5  | 40.5                  | 43.0                  | 65.0                 | 80.0                           | 24.0                         | 4.0                        | 8.0      | 5.49{560}                                 | 10.8                    | 26.6{2710}           | 36.3{3700}           |
| RF17200    | 200               |                                       |   |                       |                       |                      |                                |                              |                            |          | 21.0                                      |                         |                      |                      |
| RF17250    | 250               | 51.4                                  | 109.5   | 51.5                  | 58.0                  | 80.0                 | 100.0                          | 34.0                         | 5.0                        | 12.0     | 9.81{1000}                                | 18.0                    | 35.0{3570}           | 54.9{5600}           |
| RF17300    | 300               |                                       |   |                       |                       |                      |                                |                              |                            |          | 16.0                                      |                         |                      |                      |
| RF26250    | 250               |                                       |   |                       |                       |                      |                                |                              |                            |          | 27.0                                      |                         |                      |                      |
| RF26300    | 300               | 57.2                                  | 116.5   | 55.5                  | 61.0                  | 100.0                | 125.0                          | 38.0                         | 6.0                        | 13.0     | 13.7{1400}                                | 24.0                    | 44.9{4570}           | 72.6{7400}           |
| RF26450    | 450               |                                       |   |                       |                       |                      |                                |                              |                            |          | 19.0                                      |                         |                      |                      |
| RF36300    | 300               |                                       |   |                       |                       |                      |                                |                              |                            |          | 42.0                                      |                         |                      |                      |
| RF36450    | 450               | 66.7                                  | 146.0   | 68.0                  | 78.0                  | 125.0                | 150.0                          | 42.0                         | 7.0                        | 14.0     | 18.6{1900}                                | 33.0                    | 68.0{6930}           | 97.1{9900}           |
| RF36600    | 600               |                                       |   |                       |                       |                      |                                |                              |                            |          | 29.0                                      |                         |                      |                      |

- Note: 1. Chain cannot be used for conveyance in environments where it will be fully covered in dust.  
 2. Periodically lubricate the base chain using the grease nipple on the pin head.  
 3. Base chain is compatible with General Use Conveyor Chains and can use current sprockets.  
 4. Do not use in corrosive environments. (Exposed to or submersed in water, etc.)  
 5. The above dimensions are nominal dimensions and may differ from actual dimensions.



# Lube-Free Series (Standard Specs)

Lube-Free Series Bearing Roller Conveyor Chain uses special cylindrical bearings with self-lubricating functions between the bushes and rollers. The rollers can be used without additional lubrication. (Patented)  
 These rollers have the same dimensions as R and F Rollers on standard RF Conveyor Chain.

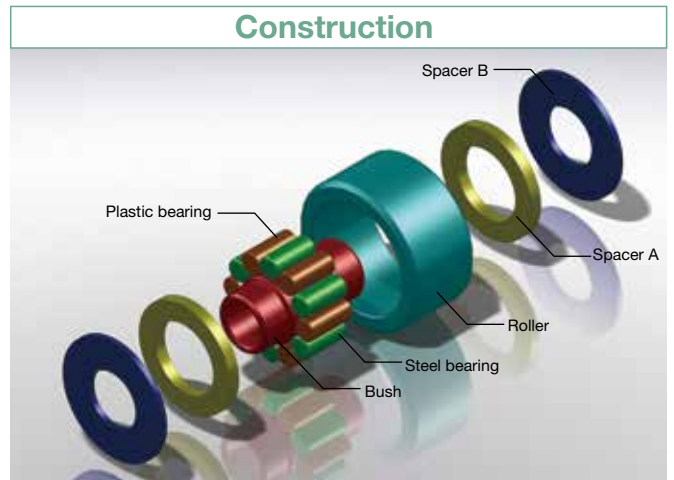
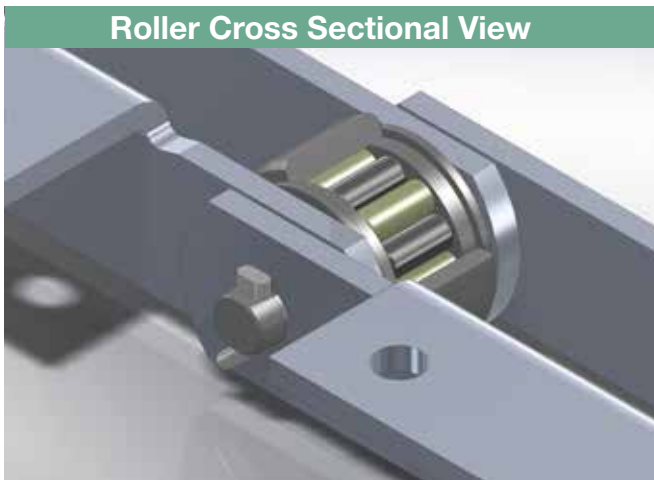

## Features

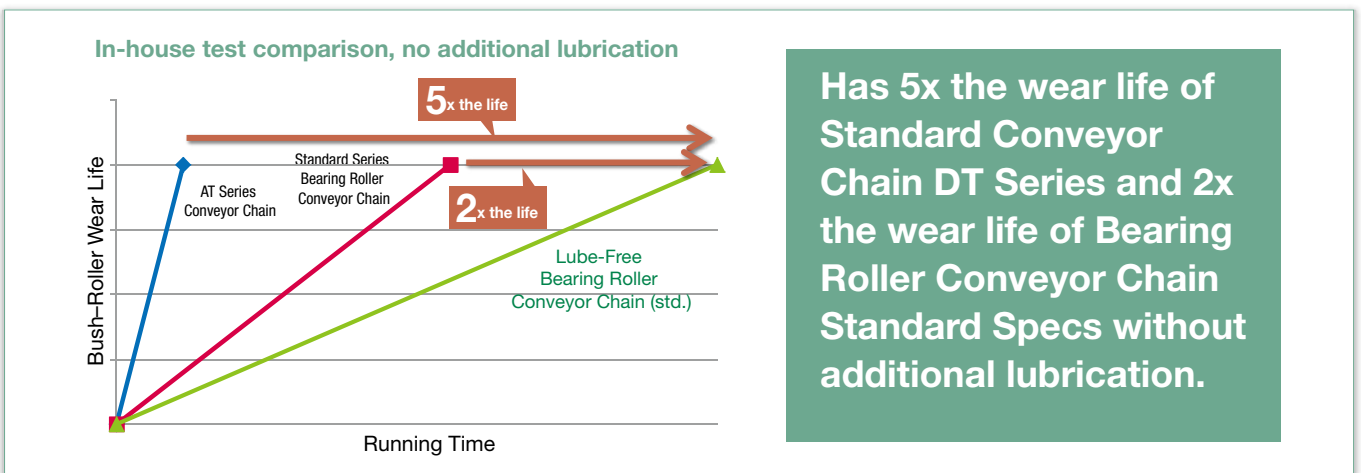

## Chain Numbering Example

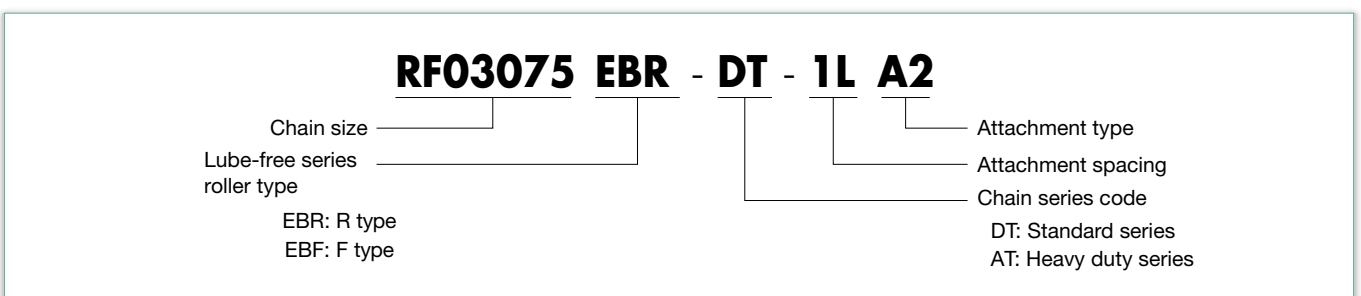

EBR Roller

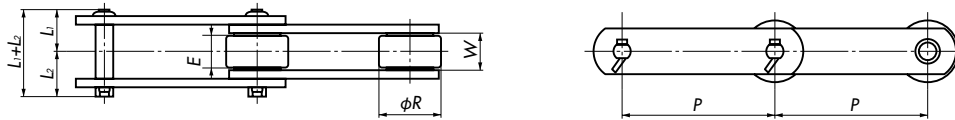

| Chain Size | Pitch<br>P | Inner Link<br>Inner Width<br>W | Pin                            |                |                | R Roller      |                         | Roller<br>Allowable<br>Load<br>kN{kgf}/pc | Approx.<br>Mass<br>kg/m | Max. Allowable Load  |                      |
|------------|------------|--------------------------------|--------------------------------|----------------|----------------|---------------|-------------------------|---|-------------------------|----------------------|----------------------|
|            |            |                                | L <sub>1</sub> +L <sub>2</sub> | L <sub>1</sub> | L <sub>2</sub> | Diameter<br>R | Flange<br>Diameter<br>E |   |                         | DT Series<br>kN{kgf} | AT Series<br>kN{kgf} |
| RF03075    | 75         | 16.1                           | 38.0                           | 18.0           | 20.0           | 31.8          | 14.0                    | 1.96{200}                                 | 2.8                     | 2.94{300}            | 5.50{560}            |
| RF03100    | 100        |                                |                                |                |                |               |                         |   |                         |                      |                      |
| RF05100    | 100        | 22.0                           | 53.5                           | 25.0           | 28.5           | 40.0          | 19.0                    | 3.04{310}                                 | 5.2                     | 6.86{700}            | 10.3{1050}           |
| RF05125    | 125        |                                |                                |                |                |               |                         |   |                         |                      |                      |
| RF05150    | 150        |                                |                                |                |                |               |                         |   |                         |                      |                      |
| RF08125    | 125        | 27.0                           | 65.5                           | 31.0           | 34.5           | 44.5          | 24.0                    | 4.12{420}                                 | 5.9                     | 7.84{800}            | 10.3{1050}           |
| RF08150    | 150        |                                |                                |                |                |               |                         |   |                         |                      |                      |
| RF10100    | 100        | 30.0                           | 69.0                           | 33.0           | 36.0           | 50.8          | 26.0                    | 5.49{560}                                 | 10.0                    | 11.3{1150}           | 16.5{1680}           |
| RF10125    | 125        |                                |                                |                |                |               |                         |   |                         |                      |                      |
| RF10150    | 150        |                                |                                |                |                |               |                         |   |                         |                      |                      |
| RF12200    | 200        | 37.1                           | 83.5                           | 40.5           | 43.0           | 65.0          | 32.0                    | 8.34{850}                                 | 11.6                    | 18.6{1900}           | 25.4{2590}           |
| RF12250    | 250        |                                |                                |                |                |               |                         |   |                         |                      |                      |
| RF17200    | 200        | 51.4                           | 109.5                          | 51.5           | 58.0           | 80.0          | 44.0                    | 14.1{1440}                                | 20.0                    | 24.5{2500}           | 38.4{3920}           |
| RF17250    | 250        |                                |                                |                |                |               |                         |   |                         |                      |                      |
| RF17300    | 300        |                                |                                |                |                |               |                         |   |                         |                      |                      |
| RF26250    | 250        | 57.2                           | 116.5                          | 55.5           | 61.0           | 100.0         | 50.0                    | 19.6{2000}                                | 26.0                    | 31.4{3200}           | 50.8{5180}           |
| RF26300    | 300        |                                |                                |                |                |               |                         |   |                         |                      |                      |
| RF26450    | 450        |                                |                                |                |                |               |                         |   |                         |                      |                      |
| RF36300    | 300        | 66.7                           | 146.0                          | 68.0           | 78.0           | 125.0         | 56.0                    | 27.5{2800}                                | 40.0                    | 47.6{4850}           | 68.0{6930}           |
| RF36450    | 450        |                                |                                |                |                |               |                         |   |                         |                      |                      |
| RF36600    | 600        |                                |                                |                |                |               |                         |   |                         |                      |                      |

Note: 1. Contact a Tsubaki representative for imperial sizes.  
2. The above dimensions are nominal dimensions and may differ from actual dimensions.

EBF Roller

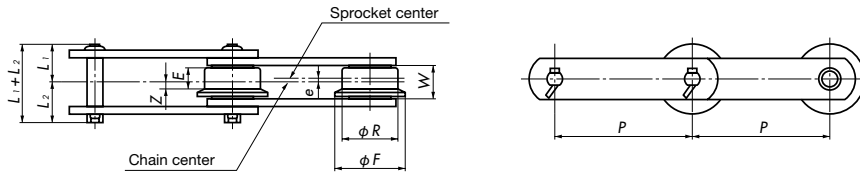

| Chain Size | Pitch<br>P | Inner Link<br>Inner Width<br>W | Pin                            |                |                | F Roller      |                         |                       |                     |      | Roller<br>Allowable<br>Load<br>kN{kgf}/pc | Approx.<br>Mass<br>kg/m | Max. Allowable Load  |                      |
|------------|------------|--------------------------------|--------------------------------|----------------|----------------|---------------|-------------------------|-----------------------|---------------------|------|---|-------------------------|----------------------|----------------------|
|            |            |                                | L <sub>1</sub> +L <sub>2</sub> | L <sub>1</sub> | L <sub>2</sub> | Diameter<br>R | Flange<br>Diameter<br>F | Contact<br>Width<br>E | Off-<br>Center<br>e | Z    |   |                         | DT Series<br>kN{kgf} | AT Series<br>kN{kgf} |
| RF03075    | 75         | 16.1                           | 38.0                           | 18.0           | 20.0           | 31.8          | 42.0                    | 11.0                  | 1.5                 | 4.3  | 1.27{130}                                 | 2.9                     | 29.4{300}            | 5.50{560}            |
| RF03100    | 100        |                                |                                |                |                |               |                         |                       |                     |      |   |                         |                      |                      |
| RF05100    | 100        | 22.0                           | 53.5                           | 25.0           | 28.5           | 40.0          | 50.0                    | 14.0                  | 2.5                 | 4.5  | 1.96{200}                                 | 5.4                     | 6.86{700}            | 10.3{1050}           |
| RF05125    | 125        |                                |                                |                |                |               |                         |                       |                     |      |   |                         |                      |                      |
| RF05150    | 150        |                                |                                |                |                |               |                         |                       |                     |      |   |                         |                      |                      |
| RF08125    | 125        | 27.0                           | 65.5                           | 31.0           | 34.5           | 44.5          | 55.0                    | 18.0                  | 2.5                 | 6.5  | 2.65{270}                                 | 6.2                     | 7.84{800}            | 10.3{1050}           |
| RF08150    | 150        |                                |                                |                |                |               |                         |                       |                     |      |   |                         |                      |                      |
| RF10125    | 125        | 30.0                           | 69.0                           | 33.0           | 36.0           | 50.8          | 65.0                    | 20.0                  | 3.0                 | 7.0  | 3.43{350}                                 | 9.0                     | 11.3{1150}           | 16.5{1680}           |
| RF10150    | 150        |                                |                                |                |                |               |                         |                       |                     |      |   |                         |                      |                      |
| RF12200    | 200        | 37.1                           | 83.5                           | 40.5           | 43.0           | 65.0          | 80.0                    | 24.0                  | 4.0                 | 8.0  | 5.49{560}                                 | 12.1                    | 18.6{1900}           | 25.4{2590}           |
| RF12250    | 250        |                                |                                |                |                |               |                         |                       |                     |      |   |                         |                      |                      |
| RF17200    | 200        | 51.4                           | 109.5                          | 51.5           | 58.0           | 80.0          | 100.0                   | 34.0                  | 5.0                 | 12.0 | 9.81{1000}                                | 21.0                    | 24.5{2500}           | 38.4{3920}           |
| RF17250    | 250        |                                |                                |                |                |               |                         |                       |                     |      |   |                         |                      |                      |
| RF17300    | 300        |                                |                                |                |                |               |                         |                       |                     |      |   |                         |                      |                      |
| RF26250    | 250        | 57.2                           | 116.5                          | 55.5           | 61.0           | 100.0         | 125.0                   | 38.0                  | 6.0                 | 13.0 | 13.7{1400}                                | 27.0                    | 31.4{3200}           | 50.8{5180}           |
| RF26300    | 300        |                                |                                |                |                |               |                         |                       |                     |      |   |                         |                      |                      |
| RF26450    | 450        |                                |                                |                |                |               |                         |                       |                     |      |   |                         |                      |                      |
| RF36300    | 300        | 66.7                           | 146.0                          | 68.0           | 78.0           | 125.0         | 150.0                   | 42.0                  | 7.0                 | 14.0 | 18.6{1900}                                | 42.0                    | 47.6{4850}           | 68.0{6930}           |
| RF36450    | 450        |                                |                                |                |                |               |                         |                       |                     |      |   |                         |                      |                      |
| RF36600    | 600        |                                |                                |                |                |               |                         |                       |                     |      |   |                         |                      |                      |

Note: 1. Contact a Tsubaki representative for imperial sizes.  
2. The above dimensions are nominal dimensions and may differ from actual dimensions.

# Lube-Free Series (Completely Lube-Free Specs)

Completely Lube-Free Bearing Roller Conveyor Chain uses special cylindrical bearings with self-lubricating functions between the bushes and rollers, and further includes a solid lubricant to eliminate the need for additional lubrication.

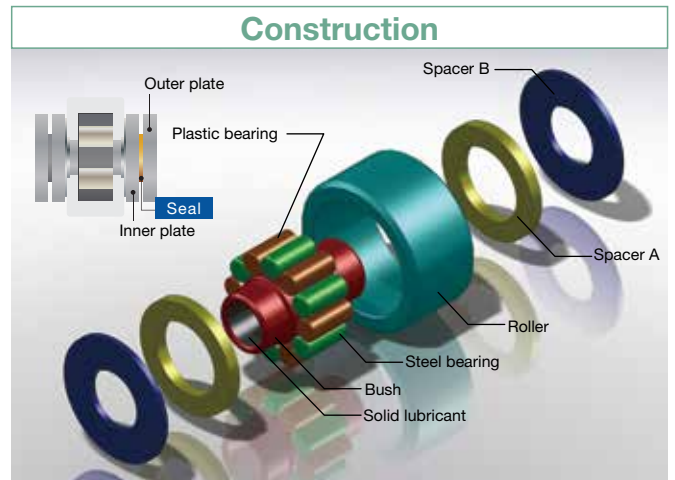
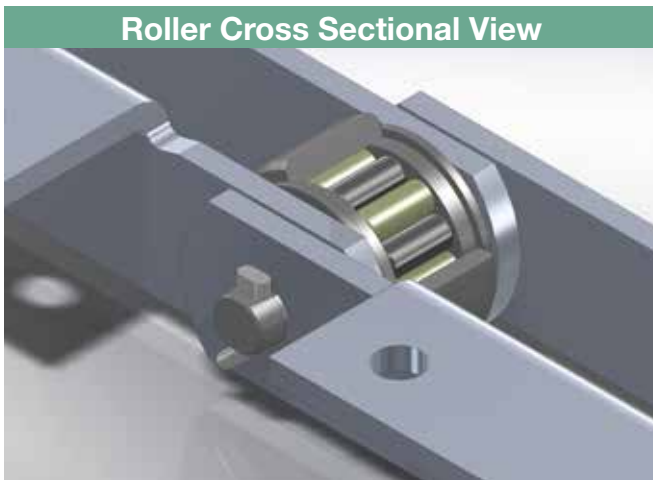

## Features

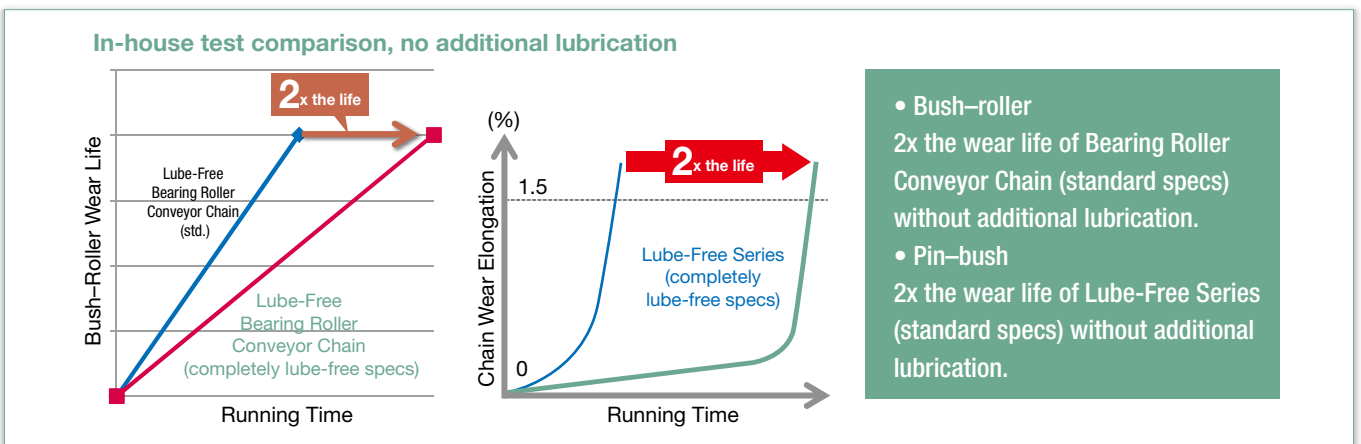

## Chain Numbering Example

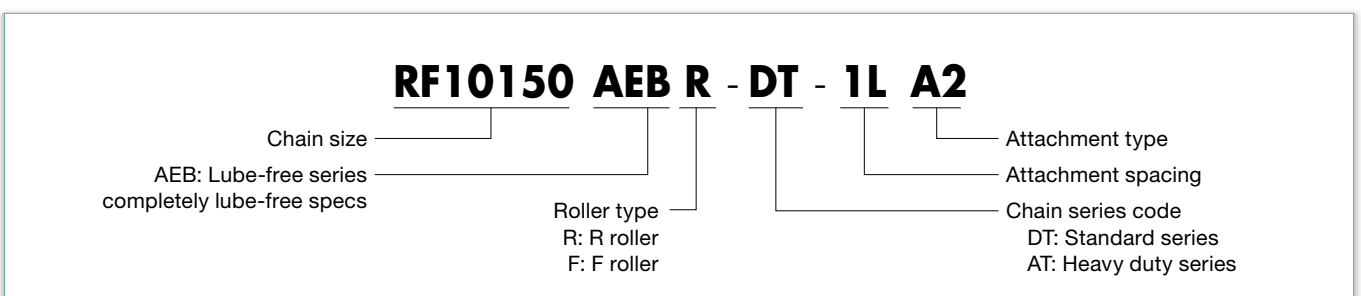



**AEBR Roller**

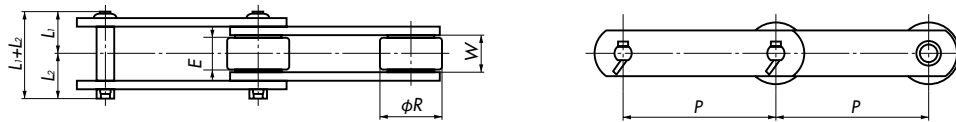

| Chain Size | Pitch<br><i>P</i> | Inner Link<br>Inner Width<br><i>W</i> | Pin   |                       |                       | R Roller             |                              | Roller<br>Allowable<br>Load<br>kN{kgf}/pc | Approx.<br>Mass<br>kg/m | Max. Allowable Load  |                      |
|------------|-------------------|---------------------------------------|---|-----------------------|-----------------------|----------------------|------------------------------|---|-------------------------|----------------------|----------------------|
|            |                   |                                       | <i>L</i> <sub>1</sub> + <i>L</i> <sub>2</sub> | <i>L</i> <sub>1</sub> | <i>L</i> <sub>2</sub> | Diameter<br><i>R</i> | Contact<br>Width<br><i>E</i> |   |                         | DT Series<br>kN{kgf} | AT Series<br>kN{kgf} |
| RF05100    | 100               | 23.0                                  | 58.0  | 27.0                  | 31.0                  | 40.0                 | 19.0                         | 3.04{310}                                 | 5.2                     | 6.86{700}            | 10.3{1050}           |
| RF05125    | 125               |                                       |   |                       |                       |                      |                              |   |                         |                      |                      |
| RF05150    | 150               |                                       |   |                       |                       |                      |                              |   |                         |                      |                      |
| RF08125    | 125               | 28.5                                  | 70.5  | 33.5                  | 37.0                  | 44.5                 | 24.0                         | 4.12{420}                                 | 5.9                     | 7.84{800}            | 10.3{1050}           |
| RF08150    | 150               |                                       |   |                       |                       |                      |                              |   |                         |                      |                      |
| RF10100    | 100               | 31.5                                  | 74.0  | 35.5                  | 38.5                  | 50.8                 | 26.0                         | 5.49{560}                                 | 10.0                    | 11.3{1150}           | 16.5{1680}           |
| RF10125    | 125               |                                       |   |                       |                       |                      |                              |   |                         |                      |                      |
| RF10150    | 150               |                                       |   |                       |                       |                      |                              |   |                         |                      |                      |
| RF12200    | 200               | 37.5                                  | 87.0  | 42.0                  | 45.0                  | 65.0                 | 32.0                         | 8.34{850}                                 | 11.6                    | 18.6{1900}           | 25.4{2590}           |
| RF12250    | 250               |                                       |   |                       |                       |                      |                              |   |                         |                      |                      |
| RF17200    | 200               | 51.5                                  | 113.0   | 53.5                  | 59.5                  | 80.0                 | 44.0                         | 14.1{1440}                                | 20.0                    | 24.5{2500}           | 38.4{3920}           |
| RF17250    | 250               |                                       |   |                       |                       |                      |                              |   |                         |                      |                      |
| RF17300    | 300               |                                       |   |                       |                       |                      |                              |   |                         |                      |                      |
| RF26250    | 250               | 57.5                                  | 120.0   | 57.5                  | 62.5                  | 100.0                | 50.0                         | 19.6{2000}                                | 26.0                    | 31.4{3200}           | 50.8{5180}           |
| RF26300    | 300               |                                       |   |                       |                       |                      |                              |   |                         |                      |                      |

Note: 1. This chain is interchangeable with standard large size conveyor chain and can use the existing sprocket. However, the L1 + L2 dimension is different.  
 2. The above dimensions are nominal dimensions and may differ from actual dimensions.

**AEBF Roller**

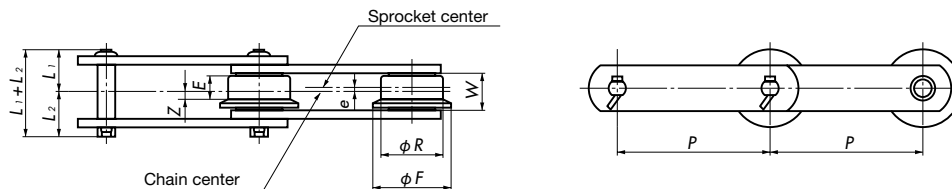

| Chain Size | Pitch<br><i>P</i> | Inner Link<br>Inner Width<br><i>W</i> | Pin   |                       |                       | F Roller             |                                |                              |                            |          | Roller<br>Allowable<br>Load<br>kN{kgf}/pc | Approx.<br>Mass<br>kg/m | Max. Allowable Load  |                      |
|------------|-------------------|---------------------------------------|---|-----------------------|-----------------------|----------------------|--------------------------------|------------------------------|----------------------------|----------|---|-------------------------|----------------------|----------------------|
|            |                   |                                       | <i>L</i> <sub>1</sub> + <i>L</i> <sub>2</sub> | <i>L</i> <sub>1</sub> | <i>L</i> <sub>2</sub> | Diameter<br><i>R</i> | Flange<br>Diameter<br><i>F</i> | Contact<br>Width<br><i>E</i> | Off-<br>Center<br><i>e</i> | <i>Z</i> |   |                         | DT Series<br>kN{kgf} | AT Series<br>kN{kgf} |
| RF05100    | 100               | 23.0                                  | 58.0  | 27.0                  | 31.0                  | 40.0                 | 50.0                           | 14.0                         | 2.5                        | 4.5      | 1.96{200}                                 | 5.4                     | 6.86{700}            | 10.3{1050}           |
| RF05125    | 125               |                                       |   |                       |                       |                      |                                |                              |                            |          |   |                         |                      |                      |
| RF05150    | 150               |                                       |   |                       |                       |                      |                                |                              |                            |          |   |                         |                      |                      |
| RF08125    | 125               | 28.5                                  | 70.5  | 33.5                  | 37.0                  | 44.5                 | 55.0                           | 18.0                         | 2.5                        | 6.5      | 2.65{270}                                 | 6.2                     | 7.84{800}            | 10.3{1050}           |
| RF08150    | 150               |                                       |   |                       |                       |                      |                                |                              |                            |          |   |                         |                      |                      |
| RF10125    | 125               | 31.5                                  | 74.0  | 35.5                  | 38.5                  | 50.8                 | 65.0                           | 20.0                         | 3.0                        | 7.0      | 3.43{350}                                 | 9.0                     | 11.3{1150}           | 16.5{1680}           |
| RF10150    | 150               |                                       |   |                       |                       |                      |                                |                              |                            |          |   |                         |                      |                      |
| RF12200    | 200               | 37.5                                  | 87.0  | 42.0                  | 45.0                  | 65.0                 | 80.0                           | 24.0                         | 4.0                        | 8.0      | 5.49{560}                                 | 12.1                    | 18.6{1900}           | 25.4{2590}           |
| RF12250    | 250               |                                       |   |                       |                       |                      |                                |                              |                            |          |   |                         |                      |                      |
| RF17200    | 200               | 51.5                                  | 113.0   | 53.5                  | 59.5                  | 80.0                 | 100.0                          | 34.0                         | 5.0                        | 12.0     | 9.81{1000}                                | 21.0                    | 24.5{2500}           | 38.4{3920}           |
| RF17250    | 250               |                                       |   |                       |                       |                      |                                |                              |                            |          |   |                         |                      |                      |
| RF17300    | 300               |                                       |   |                       |                       |                      |                                |                              |                            |          |   |                         |                      |                      |
| RF26250    | 250               | 57.5                                  | 120.0   | 57.5                  | 62.5                  | 100.0                | 125.0                          | 38.0                         | 6.0                        | 13.0     | 13.7{1400}                                | 27.0                    | 31.4{3200}           | 50.8{5180}           |
| RF26300    | 300               |                                       |   |                       |                       |                      |                                |                              |                            |          |   |                         |                      |                      |

Note: 1. This chain is interchangeable with standard large size conveyor chain and can use the existing sprocket. However, the L1 + L2 dimension is different.  
 2. The above dimensions are nominal dimensions and may differ from actual dimensions.

# Lube-Free Series (Water Resistant Specs)

Lube-Free Series Water Resistant Bearing Roller Conveyor Chain features stainless steel cylindrical bearings and special cylindrical bearings with self-lubricating functions between bushes and rollers. The rollers can be used without additional lubrication, even in contact with water. (Patented)

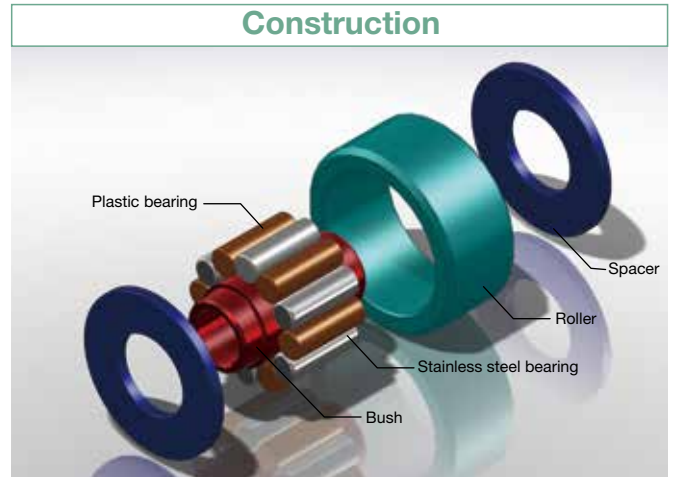
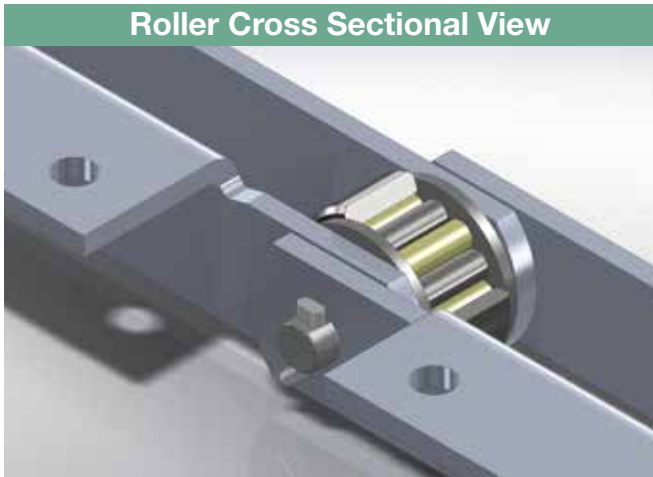

## Features

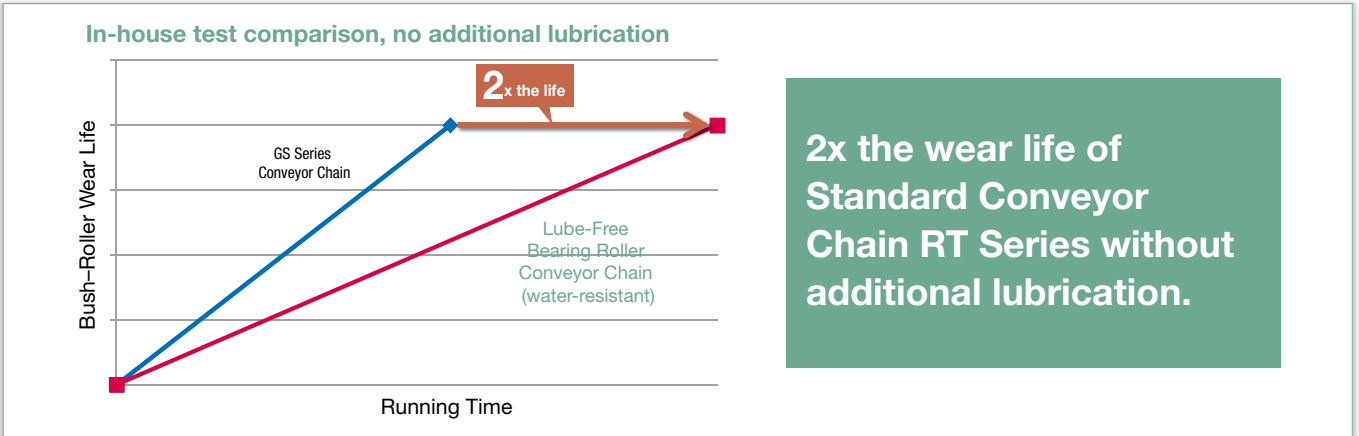

## Chain Numbering Example

**RF03075 WEBR GS - 1L A2**

Chain size \_\_\_\_\_ Attachment type \_\_\_\_\_  
 Lube-free series, water resistant specs \_\_\_\_\_ Attachment spacing \_\_\_\_\_  
 roller type WEBR: R type \_\_\_\_\_ Chain series code \_\_\_\_\_  
 WEBF: F type \_\_\_\_\_ GS: Corrosion resistant series

### ⚠ Rail mounting

When using Lube-free Series Water Resistant Specs, be sure to use a grooved rail. There is little difference in roller and spacer diameters, so the groove width (U) needs to be larger than the inner link inner width (W). Recommended rail groove depth can be found in the table on the right.

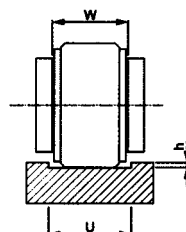

| Chain size | Rail groove depth h |
|------------|---------------------|
| RF03       | 1.6                 |
| RF05       | 1.6                 |
| RF08       | 1.6                 |
| RF10       | 2.1                 |
| RF12       | 2.1                 |
| RF17       | 2.1                 |
| RF26       | 2.1                 |
| RF36       | 2.6                 |

## WEBR Roller

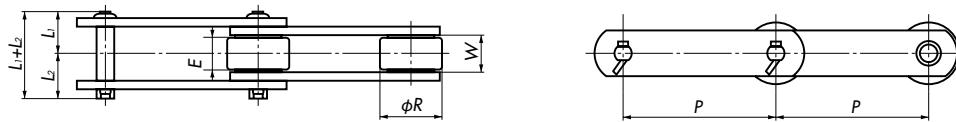

| Chain Size | Pitch<br><i>P</i> | Inner Link<br>Inner Width<br><i>W</i> | Pin   |                       |                       | R Roller             |                              | Roller<br>Allowable<br>Load<br>kN{kgf}/pc | Approx.<br>Mass<br>kg/m | Max.<br>Allowable<br>Load<br>kN{kgf} |
|------------|-------------------|---------------------------------------|---|-----------------------|-----------------------|----------------------|------------------------------|---|-------------------------|--------------------------------------|
|            |                   |                                       | <i>L</i> <sub>1</sub> + <i>L</i> <sub>2</sub> | <i>L</i> <sub>1</sub> | <i>L</i> <sub>2</sub> | Diameter<br><i>R</i> | Contact<br>Width<br><i>E</i> |   |                         |                                      |
| RF03075    | 75                | 16.1                                  | 38.0  | 18.0                  | 20.0                  | 31.8                 | 12.3                         | 1.37{140}                                 | 2.8                     | 2.94{300}                            |
| RF03100    | 100               |                                       |   |                       |                       |                      |                              |   | 2.4                     |                                      |
| RF05100    | 100               | 22.0                                  | 53.5  | 25.0                  | 28.5                  | 40.0                 | 17.0                         | 2.13{220}                                 | 5.2                     | 6.86{700}                            |
| RF05125    | 125               |                                       |   |                       |                       |                      |                              |   | 4.5                     |                                      |
| RF05150    | 150               | 27.0                                  | 65.5  | 31.0                  | 34.5                  | 44.5                 | 21.0                         | 2.88{290}                                 | 4.2                     | 7.84{800}                            |
| RF08125    | 125               |                                       |   |                       |                       |                      |                              |   | 5.9                     |                                      |
| RF08150    | 150               | 30.0                                  | 69.0  | 33.0                  | 36.0                  | 50.8                 | 23.0                         | 3.84{390}                                 | 5.6                     | 11.3{1150}                           |
| RF10100    | 100               |                                       |   |                       |                       |                      |                              |   | 8.7                     |                                      |
| RF10125    | 125               | 37.1                                  | 83.5  | 40.5                  | 43.0                  | 65.0                 | 28.0                         | 5.84{600}                                 | 8.0                     | 18.6{1900}                           |
| RF10150    | 150               |                                       |   |                       |                       |                      |                              |   | 11.6                    |                                      |
| RF12200    | 200               | 51.4                                  | 109.5   | 51.5                  | 58.0                  | 80.0                 | 40.0                         | 9.87{1010}                                | 10.4                    | 24.5{2500}                           |
| RF12250    | 250               |                                       |   |                       |                       |                      |                              |   | 20.0                    |                                      |
| RF17200    | 200               | 57.2                                  | 116.5   | 55.5                  | 61.0                  | 100.0                | 46.0                         | 13.7{1400}                                | 16.0                    | 31.4{3200}                           |
| RF17250    | 250               |                                       |   |                       |                       |                      |                              |   | 26.0                    |                                      |
| RF17300    | 300               | 66.7                                  | 146.0   | 68.0                  | 78.0                  | 125.0                | 55.0                         | 19.3{1970}                                | 23.0                    | 47.6{4850}                           |
| RF26250    | 250               |                                       |   |                       |                       |                      |                              |   | 40.0                    |                                      |
| RF26300    | 300               | 66.7                                  | 146.0   | 68.0                  | 78.0                  | 125.0                | 55.0                         | 19.3{1970}                                | 40.0                    | 47.6{4850}                           |
| RF36300    | 300               |                                       |   |                       |                       |                      |                              |   | 40.0                    |                                      |

Note: 1. Contact a Tsubaki representative for imperial sizes.  
 2. The above dimensions are nominal dimensions and may differ from actual dimensions.

## WEBF Roller

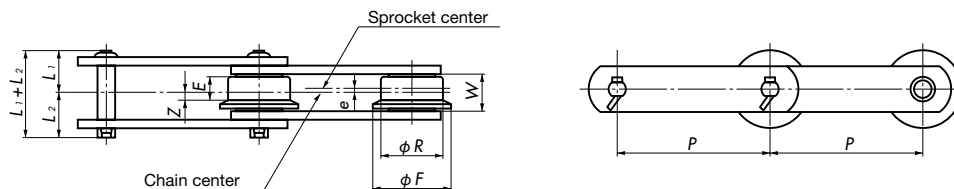

| Chain Size | Pitch<br><i>P</i> | Inner Link<br>Inner Width<br><i>W</i> | Pin   |                       |                       | F Roller             |                                |                              |                            |          | Roller<br>Allowable<br>Load<br>kN{kgf}/pc | Approx.<br>Mass<br>kg/m | Max.<br>Allowable<br>Load<br>kN{kgf} |
|------------|-------------------|---------------------------------------|---|-----------------------|-----------------------|----------------------|--------------------------------|------------------------------|----------------------------|----------|---|-------------------------|--------------------------------------|
|            |                   |                                       | <i>L</i> <sub>1</sub> + <i>L</i> <sub>2</sub> | <i>L</i> <sub>1</sub> | <i>L</i> <sub>2</sub> | Diameter<br><i>R</i> | Flange<br>Diameter<br><i>F</i> | Contact<br>Width<br><i>E</i> | Off-<br>Center<br><i>e</i> | <i>Z</i> |   |                         |                                      |
| RF03075    | 75                | 16.1                                  | 38.0  | 18.0                  | 20.0                  | 31.8                 | 42.0                           | 9.1                          | 1.6                        | 3.0      | 0.89{90}                                  | 2.9                     | 2.94{300}                            |
| RF03100    | 100               |                                       |   |                       |                       |                      |                                |                              |                            |          |   | 2.5                     |                                      |
| RF05100    | 100               | 22.0                                  | 53.5  | 25.0                  | 28.5                  | 40.0                 | 50.0                           | 13.0                         | 2.0                        | 4.5      | 1.37{140}                                 | 5.4                     | 6.86{700}                            |
| RF05125    | 125               |                                       |   |                       |                       |                      |                                |                              |                            |          |   | 4.6                     |                                      |
| RF05150    | 150               | 27.0                                  | 65.5  | 31.0                  | 34.5                  | 44.5                 | 55.0                           | 17.0                         | 2.0                        | 6.5      | 1.86{190}                                 | 4.4                     | 7.84{800}                            |
| RF08125    | 125               |                                       |   |                       |                       |                      |                                |                              |                            |          |   | 6.2                     |                                      |
| RF08150    | 150               | 30.0                                  | 69.0  | 33.0                  | 36.0                  | 50.8                 | 65.0                           | 18.5                         | 2.3                        | 7.0      | 2.40{240}                                 | 5.8                     | 11.3{1150}                           |
| RF10125    | 125               |                                       |   |                       |                       |                      |                                |                              |                            |          |   | 9.0                     |                                      |
| RF10150    | 150               | 37.1                                  | 83.5  | 40.5                  | 43.0                  | 65.0                 | 80.0                           | 22.0                         | 3.0                        | 8.0      | 3.84{390}                                 | 8.3                     | 18.6{1900}                           |
| RF12200    | 200               |                                       |   |                       |                       |                      |                                |                              |                            |          |   | 12.1                    |                                      |
| RF12250    | 250               | 51.4                                  | 109.5   | 51.5                  | 58.0                  | 80.0                 | 100.0                          | 32.0                         | 4.0                        | 12.0     | 6.87{700}                                 | 10.8                    | 24.5{2500}                           |
| RF17200    | 200               |                                       |   |                       |                       |                      |                                |                              |                            |          |   | 21.0                    |                                      |
| RF17250    | 250               | 57.2                                  | 116.5   | 55.5                  | 61.0                  | 100.0                | 125.0                          | 36.0                         | 5.0                        | 13.0     | 9.59{980}                                 | 16.0                    | 31.4{3200}                           |
| RF17300    | 300               |                                       |   |                       |                       |                      |                                |                              |                            |          |   | 27.0                    |                                      |
| RF26250    | 250               | 66.7                                  | 146.0   | 68.0                  | 78.0                  | 125.0                | 150.0                          | 43.0                         | 6.0                        | 15.5     | 13.0{1330}                                | 24.0                    | 47.6{4850}                           |
| RF26300    | 300               |                                       |   |                       |                       |                      |                                |                              |                            |          |   | 42.0                    |                                      |
| RF36300    | 300               | 66.7                                  | 146.0   | 68.0                  | 78.0                  | 125.0                | 150.0                          | 43.0                         | 6.0                        | 15.5     | 13.0{1330}                                | 42.0                    | 47.6{4850}                           |

Note: 1. Contact a Tsubaki representative for imperial sizes.  
 2. The above dimensions are nominal dimensions and may differ from actual dimensions.



# Attachment Dimensional Chart

## A1/K1 Attachments

| Chain Size | Bearing Roller Type |          | Pitch P | S   | C    | 2C  | X   | 2X  | N   | T   | O  | Bolt Used | Additional Mass/Each kg |
|------------|---------------------|----------|---------|-----|------|-----|-----|-----|-----|-----|----|-----------|-------------------------|
|            | R Roller            | F Roller |         |     |      |     |     |     |     |     |    |           |                         |
| RF03075    | ○                   | ○        | 75      | 20  | 30   | 60  | 46  | 92  | 55  | 3.2 | 10 | M8        | 0.06                    |
| RF03100    | ○                   | ○        | 100     |     |      |     |     |     | 65  |     |    |           | 0.07                    |
| RF05100    | ○                   | ○        | 100     | 22  | 35   | 70  | 47  | 94  | 65  | 4.5 | 10 | M8        | 0.07                    |
| RF05125    | ○                   | ○        | 125     |     |      |     |     |     | 75  |     |    |           | 0.08                    |
| RF05150    | ○                   | ○        | 150     | 28  | 50   | 100 | 64  | 128 | 85  | 6.3 | 12 | M10       | 0.10                    |
| RF08125    | ○                   | ○        | 125     |     |      |     |     |     | 80  |     |    |           | 0.19                    |
| RF08150    | ○                   | ○        | 150     | 28  | 50   | 100 | 67  | 134 | 90  | 6.3 | 12 | M10       | 0.23                    |
| RF10100    | ○                   | —        | 100     |     |      |     |     |     | 70  |     |    |           | 0.16                    |
| RF10125    | ○                   | ○        | 125     | 38  | 60   | 120 | 79  | 158 | 80  | 7.9 | 15 | M12       | 0.18                    |
| RF10150    | ○                   | ○        | 150     |     |      |     |     |     | 90  |     |    |           | 0.20                    |
| RF12200    | ○                   | ○        | 200     | 45  | 75   | 150 | 100 | 200 | 120 | 9.5 | 15 | M12       | 0.44                    |
| RF12250    | ○                   | ○        | 250     |     |      |     |     |     | 170 |     |    |           | 0.61                    |
| RF17200    | ○                   | ○        | 200     | 55  | 80   | 160 | 108 | 216 | 120 | 9.5 | 15 | M12       | 0.64                    |
| RF17250    | ○                   | ○        | 250     |     |      |     |     |     | 170 |     |    |           | 0.88                    |
| RF17300    | ○                   | ○        | 300     | 55  | 80   | 160 | 108 | 216 | 220 | 9.5 | 15 | M12       | 1.26                    |
| RF26250    | ○                   | ○        | 250     |     |      |     |     |     | 170 |     |    |           | 1.01                    |
| RF26300    | ○                   | ○        | 300     | 220 | 1.34 |     |     |     |     |     |    |           |                         |

- Note: 1. The weight of the A attachment in the table is the additional weight per attachment. This value should be double for K attachments.  
 2. Please contact a Tsubaki representative if the A or K attachment side face requires a guide.  
 3. When attaching a slat or the like between two strands of chain, the slats should be attached to either outer link-outer link or inner link-inner link.  
 4. Imperial sizes available upon request. 5. The above dimensions are nominal dimensions and may differ from actual dimensions.

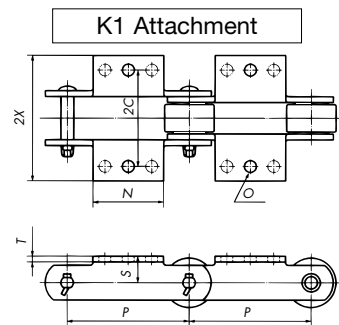
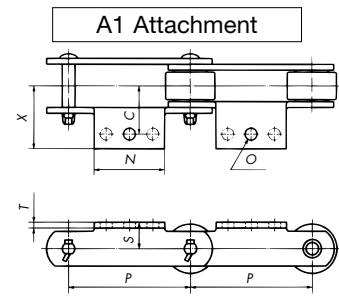

## A2/K2 Attachments

| Chain Size | Bearing Roller Type |          | Pitch P | S   | C   | 2C   | X   | 2X  | N   | K   | T   | O  | Bolt Used | Additional Mass/Each kg |
|------------|---------------------|----------|---------|-----|-----|------|-----|-----|-----|-----|-----|----|-----------|-------------------------|
|            | R Roller            | F Roller |         |     |     |      |     |     |     |     |     |    |           |                         |
| RF03075    | ○                   | ○        | 75      | 20  | 30  | 60   | 46  | 92  | 55  | 30  | 3.2 | 10 | M8        | 0.06                    |
| RF03100    | ○                   | ○        | 100     |     |     |      |     |     | 65  | 40  |     |    |           | 0.07                    |
| RF05100    | ○                   | ○        | 100     | 22  | 35  | 70   | 47  | 94  | 65  | 40  | 4.5 | 10 | M8        | 0.07                    |
| RF05125    | ○                   | ○        | 125     |     |     |      |     |     | 75  | 50  |     |    |           | 0.08                    |
| RF05150    | ○                   | ○        | 150     | 28  | 50  | 100  | 64  | 128 | 85  | 60  | 6.3 | 12 | M10       | 0.10                    |
| RF08125    | ○                   | ○        | 125     |     |     |      |     |     | 80  | 50  |     |    |           | 0.19                    |
| RF08150    | ○                   | ○        | 150     | 28  | 50  | 100  | 67  | 134 | 90  | 60  | 6.3 | 12 | M10       | 0.23                    |
| RF10100    | ○                   | —        | 100     |     |     |      |     |     | 70  | 40  |     |    |           | 0.16                    |
| RF10125    | ○                   | ○        | 125     | 38  | 60  | 120  | 79  | 158 | 80  | 50  | 7.9 | 15 | M12       | 0.18                    |
| RF10150    | ○                   | ○        | 150     |     |     |      |     |     | 90  | 60  |     |    |           | 0.20                    |
| RF12200    | ○                   | ○        | 200     | 45  | 75  | 150  | 100 | 200 | 120 | 80  | 9.5 | 15 | M12       | 0.44                    |
| RF12250    | ○                   | ○        | 250     |     |     |      |     |     | 170 | 125 |     |    |           | 0.61                    |
| RF17200    | ○                   | ○        | 200     | 55  | 80  | 160  | 108 | 216 | 120 | 80  | 9.5 | 15 | M12       | 0.64                    |
| RF17250    | ○                   | ○        | 250     |     |     |      |     |     | 170 | 125 |     |    |           | 0.88                    |
| RF17300    | ○                   | ○        | 300     | 55  | 80  | 160  | 108 | 216 | 220 | 180 | 9.5 | 15 | M12       | 1.26                    |
| RF26250    | ○                   | ○        | 250     |     |     |      |     |     | 170 | 125 |     |    |           | 1.01                    |
| RF26300    | ○                   | ○        | 300     | 220 | 180 | 1.34 |     |     |     |     |     |    |           |                         |

- Note: 1. The weight of the A attachment in the table is the additional weight per attachment. This value should be double for K attachments.  
 2. Please contact a Tsubaki representative if the A or K attachment side face requires a guide.  
 3. When attaching a slat or the like between two strands of chain, the slats should be attached to either outer link-outer link or inner link-inner link.  
 4. Imperial sizes available upon request. 5. The above dimensions are nominal dimensions and may differ from actual dimensions.

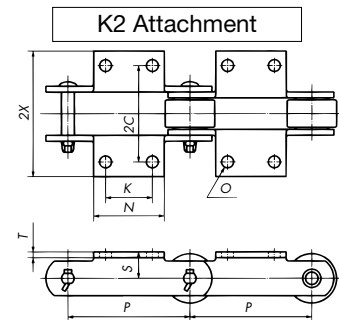
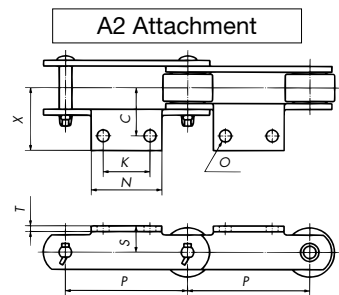

## YA2 (Welded) Attachments

| Chain Size | Bearing Roller Type |          | Pitch P | S  | C   | 2C  | X     | 2X  | N   | K   | O  | Angle Used      | Bolt Used | Additional Mass/Each kg |
|------------|---------------------|----------|---------|----|-----|-----|-------|-----|-----|-----|----|-----------------|-----------|-------------------------|
|            | R Roller            | F Roller |         |    |     |     |       |     |     |     |    |                 |           |                         |
| RF26450    | ○                   | ○        | 450     | 55 | 80  | 160 | 123.5 | 247 | 320 | 280 | 15 | L75 × 75 × 9    | M12       | 3.19                    |
| RF36300    | ○                   | ○        | 300     | 70 | 100 | 200 | 160   | 320 | 160 | 100 | 19 | L100 × 100 × 10 | M16       | 2.40                    |
| RF36450    | ○                   | ○        | 450     |    |     |     |       |     | 330 | 280 |    |                 |           | 4.90                    |
| RF36600    | ○                   | ○        | 600     |    |     |     |       |     | 410 | 360 |    |                 |           | 6.10                    |

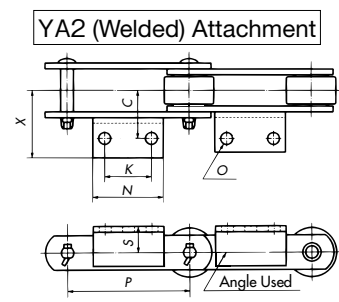

- Note: 1. When attaching a slat or the like between two strands of chain, the slats should be attached to either outer link-outer link or inner link-inner link.  
 2. Imperial sizes available upon request. 3. The above dimensions are nominal dimensions and may differ from actual dimensions.

SA2/SK2 Attachments

| Chain Size | Bearing Roller Type |        | Pitch P | S <sub>1</sub> | S <sub>2</sub> | Q <sub>1</sub> | Q <sub>2</sub> | N   | K   | T   | O  | Bolt Used | Additional Mass/Each kg |
|------------|---------------------|--------|---------|----------------|----------------|----------------|----------------|-----|-----|-----|----|-----------|-------------------------|
|            | R                   | F      |         |                |                |                |                |     |     |     |    |           |                         |
|            | Roller              | Roller |         |                |                |                |                |     |     |     |    |           |                         |
| RF03075    | ○                   | —      | 75      | 33             | 49             | 15.5           | 11.5           | 55  | 30  | 3.2 | 10 | M8        | 0.06                    |
| RF03100    | ○                   | —      | 100     |                |                |                |                | 65  | 40  |     |    |           | 0.07                    |
| RF05100    | ○                   | —      | 100     | 33.4           | 50.7           | 21             | 15.5           | 65  | 40  | 4.5 | 10 | M8        | 0.07                    |
| RF05125    | ○                   | —      | 125     |                |                |                |                | 75  | 50  |     |    |           | 0.08                    |
| RF05150    | ○                   | —      | 150     |                |                |                |                | 85  | 60  |     |    |           | 0.10                    |
| RF08125    | ○                   | —      | 125     | 46.1           | 60.7           | 27             | 20             | 80  | 50  | 6.3 | 12 | M10       | 0.19                    |
| RF08150    | ○                   | —      | 150     |                |                |                |                | 90  | 60  |     |    |           | 0.23                    |
| RF10100    | ○                   | —      | 100     | 46.1           | 63             | 28.5           | 21.5           | 70  | 40  | 6.3 | 12 | M10       | 0.16                    |
| RF10125    | ○                   | —      | 125     |                |                |                |                | 80  | 50  |     |    |           | 0.18                    |
| RF10150    | ○                   | —      | 150     |                |                |                |                | 90  | 60  |     |    |           | 0.20                    |
| RF12200    | ○                   | —      | 200     | 55             | 75.7           | 35.5           | 26.5           | 120 | 80  | 7.9 | 15 | M12       | 0.44                    |
| RF12250    | ○                   | —      | 250     |                |                |                |                | 170 | 125 |     |    |           | 0.61                    |

Note: 1. When attaching a slat or the like between two strands of chain, the slats should be attached to either outer link-outer link or inner link-inner link.  
 2. Imperial sizes available upon request.  
 3. The above dimensions are nominal dimensions and may differ from actual dimensions.

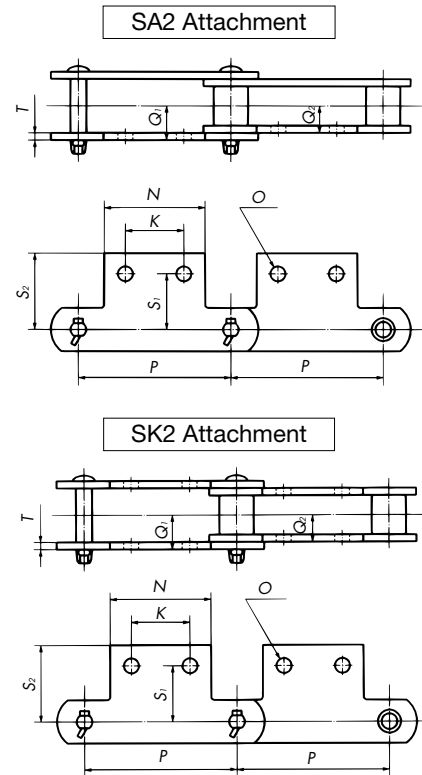

GA2 Attachments

| Chain Size | Bearing Roller Type |        | Pitch P | K   | T    | Q <sub>1</sub> | Q <sub>2</sub> | A    | O  | Max. Length of Attached Bolt |            | Bolt Used |
|------------|---------------------|--------|---------|-----|------|----------------|----------------|------|----|------------------------------|------------|-----------|
|            | R                   | F      |         |     |      |                |                |      |    | Outer Link                   | Inner Link |           |
|            | Roller              | Roller |         |     |      |                |                |      |    |                              |            |           |
| RF03075    | ○                   | —      | 75      | 30  | 3.2  | 15.5           | 11.5           | 13.5 | 8  | 26                           | 19         | M6        |
| RF03100    | ○                   | —      | 100     | 50  |      |                |                |      |    |                              |            |           |
| RF05100    | ○                   | —      | 100     | 40  | 4.5  | 21             | 15.5           | 15   | 10 | 36                           | 26         | M8        |
| RF05125    | ○                   | ○      | 125     | 50  |      |                |                |      |    |                              |            |           |
| RF05150    | ○                   | ○      | 150     | 60  |      |                |                |      |    |                              |            |           |
| RF08150    | ○                   | ○      | 150     | 60  | 6.3  | 27             | 20             | 20   | 12 | 45                           | 31         | M10       |
| RF10100    | —                   | —      | 100     | 30  |      |                |                |      |    |                              |            |           |
| RF10125    | ○                   | —      | 125     | 40  | 6.3  | 28.5           | 21.5           | 20   | 12 | 49                           | 35         | M10       |
| RF10150    | ○                   | ○      | 150     | 60  |      |                |                |      |    |                              |            |           |
| RF12200    | ○                   | ○      | 200     | 80  |      |                |                |      |    |                              |            |           |
| RF12250    | ○                   | ○      | 250     | 125 | 7.9  | 35.5           | 26.5           | 26   | 15 | 63                           | 45         | M12       |
| RF17200    | ○                   | ○      | 200     | 70  |      |                |                |      |    |                              |            |           |
| RF17250    | ○                   | ○      | 250     | 110 | 9.5  | 45.5           | 35             | 26   | 15 | 81                           | 61         | M12       |
| RF17300    | ○                   | ○      | 300     | 150 |      |                |                |      |    |                              |            |           |
| RF26300    | ○                   | ○      | 300     | 140 | 9.5  | 48.5           | 38             | 26   | 15 | 88                           | 67         | M12       |
| RF26450    | ○                   | ○      | 450     | 220 |      |                |                |      |    |                              |            |           |
| RF36450    | ○                   | ○      | 450     | 220 | 12.7 | 60             | 46             | 32   | 19 | 105                          | 75         | M16       |
| RF36600    | ○                   | ○      | 600     | 300 |      |                |                |      |    |                              |            |           |

Note: 1. The weight of a GA2 attachment is the same as the weight of the base chain.  
 2. When attaching a slat or the like between two strands of chain, the slats should be attached to either outer link-outer link or inner link-inner link.  
 3. Imperial sizes available upon request.  
 4. The above dimensions are nominal dimensions and may differ from actual dimensions.

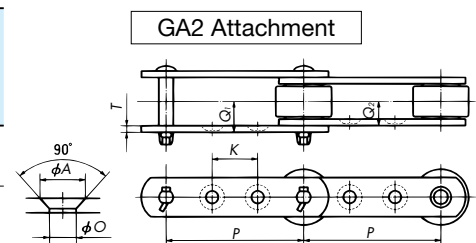

Contact a Tsubaki representative regarding attachments for Completely Lube-Free Bearing Roller Conveyor Chain.

# List of Series

| Series Specification        |   | Standard Series  |         |  |                  | Lube-Free Series                           |                  |   |                  |   |      |
|-----------------------------|---|--|---------|--|------------------|--|------------------|---|------------------|---|------|
|                             |   | Standard Specs   |         | Anti-Dust Specs  |                  | Standard Specs                             |                  | Completely Lube-Free Specs                              |                  | Water Resistant Specs   |      |
| Type                        |   | BR BF  |         | DBR DBF  |                  | EBR EBF                                    |                  | AEBR AEBF   |                  | WEBR WEBF   |      |
| Operating Environment       |   | Room temperature, away from water and dust                   |         | Dust may be present (cannot be used when chain will be buried in dust) |                  | Room temperature, away from water and dust |                  | Room temperature, away from water and dust              |                  | Room temperature, in contact with water   |      |
| Roller Lubrication          |   | Requires regular lube  |         | Requires regular lube  |                  | Can be used without lubricating the roller |                  | Packaged and shipped lubed, no further lubing necessary |                  | Packaged and shipped lubed, no further lubing necessary (cannot be used in dust environments) |      |
| Operating Temperature Range |   | -20°C to 80°C (can be manufactured to withstand up to 150°C) |         | -10°C to 80°C  |                  | -20°C to 50°C                              |                  | -20°C to 50°C   |                  | 0°C to 50°C   |      |
| Roller Allowable Load       | R Roller                                | Chain Size   | RF03    | 1.96kN { 200kgf}   | —                | —  | 1.96kN { 200kgf} | —   | —                | 1.37kN { 140kgf}  |      |
|                             |   |  | RF05    | 3.04kN { 310kgf}   | —                | —  | 3.04kN { 310kgf} | 3.04kN { 310kgf}  | 2.13kN { 220kgf} |   |      |
|                             |   |  | RF08    | 4.12kN { 420kgf}   | —                | —  | 4.12kN { 420kgf} | 4.12kN { 420kgf}  | 2.88kN { 290kgf} |   |      |
|                             |   |  | RF10    | 5.49kN { 560kgf}   | 5.49kN { 560kgf} | 5.49kN { 560kgf}                           | 5.49kN { 560kgf} | 5.49kN { 560kgf}  | 3.84kN { 390kgf} |   |      |
|                             |   |  | RF12    | 8.34kN { 850kgf}   | 8.34kN { 850kgf} | 8.34kN { 850kgf}                           | 8.34kN { 850kgf} | 8.34kN { 850kgf}  | 5.84kN { 600kgf} |   |      |
|                             |   |  | RF17    | 14.1kN {1440kgf}   | 14.1kN {1440kgf} | 14.1kN {1440kgf}                           | 14.1kN {1440kgf} | 14.1kN {1440kgf}  | 9.87kN {1010kgf} |   |      |
|                             |   |  | RF26    | 19.6kN {2000kgf}   | 19.6kN {2000kgf} | 19.6kN {2000kgf}                           | 19.6kN {2000kgf} | 19.6kN {2000kgf}  | 13.7kN {1400kgf} |   |      |
|                             |   |  | RF36    | 27.5kN {2800kgf}   | 27.5kN {2800kgf} | 27.5kN {2800kgf}                           | 27.5kN {2800kgf} | 27.5kN {2800kgf}  | 19.3kN {1970kgf} |   |      |
|                             | F Roller                                | Chain Size   | RF03    | 1.27kN { 130kgf}   | —                | —  | 1.27kN { 130kgf} | —   | —                | 0.89kN { 90kgf}   |      |
|                             |   |  | RF05    | 1.96kN { 200kgf}   | —                | —  | 1.96kN { 200kgf} | 1.96kN { 200kgf}  | 1.37kN { 140kgf} |   |      |
|                             |   |  | RF08    | 2.65kN { 270kgf}   | —                | —  | 2.65kN { 270kgf} | 2.65kN { 270kgf}  | 1.86kN { 190kgf} |   |      |
|                             |   |  | RF10    | 3.43kN { 350kgf}   | 3.43kN { 350kgf} | 3.43kN { 350kgf}                           | 3.43kN { 350kgf} | 3.43kN { 350kgf}  | 2.40kN { 240kgf} |   |      |
|                             |   |  | RF12    | 5.49kN { 560kgf}   | 5.49kN { 560kgf} | 5.49kN { 560kgf}                           | 5.49kN { 560kgf} | 5.49kN { 560kgf}  | 3.84kN { 390kgf} |   |      |
|                             |   |  | RF17    | 9.81kN {1000kgf}   | 9.81kN {1000kgf} | 9.81kN {1000kgf}                           | 9.81kN {1000kgf} | 9.81kN {1000kgf}  | 6.87kN { 700kgf} |   |      |
|                             |   |  | RF26    | 13.7kN {1400kgf}   | 13.7kN {1400kgf} | 13.7kN {1400kgf}                           | 13.7kN {1400kgf} | 13.7kN {1400kgf}  | 9.59kN { 980kgf} |   |      |
|                             |   |  | RF36    | 18.6kN {1900kgf}   | 18.6kN {1900kgf} | 18.6kN {1900kgf}                           | 18.6kN {1900kgf} | 18.6kN {1900kgf}  | 13.0kN {1330kgf} |   |      |
|                             | Coefficient of Roller Rotation Friction |  | 0.03    |  | 0.05*            |  | 0.03             |   | 0.03             |   | 0.03 |
|                             | Chain Allowable Speed                   | Sprocket No. of Teeth  | 6       | 15m/min  | 15m/min          | —  | —                | —   |                  |   |      |
| 8                           |   |  | 25m/min | 25m/min  | 15m/min          | 15m/min                                    | 15m/min          |   |                  |   |      |
| 10                          |   |  | 30m/min | 30m/min  | 20m/min          | 20m/min                                    | 20m/min          |   |                  |   |      |
| 12                          |   |  | 30m/min | 30m/min  | 25m/min          | 25m/min                                    | 25m/min          |   |                  |   |      |

\*As Anti-Dust Series chain is designed for use in dusty environments, its coefficient of friction is slightly higher.  
 • See the Tsubaki Large Size Conveyor Chains & Sprockets catalog for selection.

# Q&A

## 1 What is the difference between Tsubaki Bearing Roller Conveyor Chain and competitor bearing roller conveyor chain?

Tsubaki Bearing Roller Conveyor Chain uses a unique construction with cylindrical bearings inside the roller. Competitor chains just use two standard ball bearings.

Although bush–roller life is roughly the same with both types of construction, ball bearings receive load on their point contact and so generally have a lower allowable load than cylindrical bearings and their linear contact. Cylindrical bearings are also tough against impacts—impacts will damage the retainer of ball bearings, which easily leads to poor rotation.

## 2 Should I lubricate Bearing Roller Conveyor Chain?

We apply grease to inside the bearing rollers before we ship your chain from our plant. Although lubrication frequency will vary with the operating conditions, you should lubricate between pins–bushes and bushes–rollers once every 1–3 months (before you start hearing abnormal noises). (See the diagram below.)

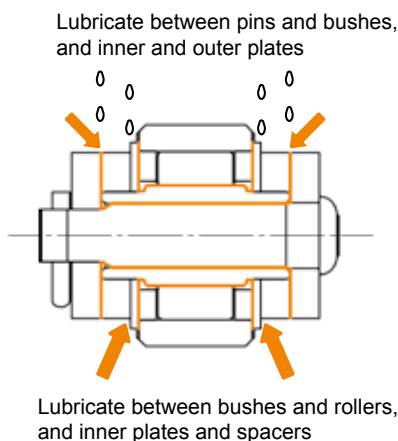

Grease nipples are also available upon request. (See pg. 6.) Consider Tsubaki's Lube-Free Bearing Roller Conveyor Chain when you wish to avoid additional lubrication or when you wish to avoid contaminating conveyed items with lube.

## 3 Setting the allowable speed and sprocket number of teeth (pg. 19)

Bearing Roller Conveyor Chain's allowable speed is established by the strength of the rollers (cylindrical bearings) when engaging the sprocket. The less teeth a sprocket has, the higher the force acting on the roller during engagement, and the rollers (cylindrical bearings) will not be able to handle the load.

## 4 What is stick-slip?

Stick-slip, also called "surging," is a type of self-induced oscillation where the chain repeatedly starts and stops, despite there being continuous drive from the drive source. Stick-slip generally happens on conveyors over 10m long and with chain speeds less than 15m/min. The causes of stick-slip include a fluctuating coefficient of friction between bushes and rollers, insufficient chain strength, or even insufficient rail or conveyor strength. In situations where it is caused by a fluctuating coefficient of friction, then using Bearing Roller Conveyor Chain can minimize this surging.



# Q&A

## 5 Are the benefits of Bearing Roller Conveyor Chain worth the price?

When replacing existing chain, the initial costs will be higher but you will be able to reduce overall costs. (See table below.)

|                   | AT Series Conveyor Chain   | Standard Bearing Roller Conveyor Chain  |
|-------------------|--|---|
| Initial costs     | 60   | 100   |
| Wear life         | 1  | 3   |
| Replacement costs | 5000 yen/hour x 4 people x 12 hours (half day) x <b>3</b> times = <b>JPY 720,000</b> | 5000 yen/hour x 4 people x 12 hours (half day) x <b>1</b> time = <b>JPY 240,000</b> |
| Chain cost        | 60 x <b>3</b> replacements = <b>180</b>  | 100 x <b>1</b> replacement = <b>100</b>   |
| Total costs       | 180 + JPY 720,000 = <b>252</b>   | 100 + JPY 240,000 = <b>124</b>  |

Note: Simulation with Bearing Roller Conveyor Chain costs as our benchmark of 100 and AT Series as 60.

### Bearing Roller Conveyor Chain has half the total costs of standard conveyor chain.

Users can additionally reduce their electric bill thanks to the lower required motor kW and prevent production losses arising from stopping the line during replacement. (See the charts at the bottom of pg. 3.) And even with new installations, since Bearing Roller Conveyor Chain has a higher roller allowable load than standard conveyor chain users can go a chain size down. A smaller chain size means more compact equipment, which can lead to lower overall costs.

## Notes on Use

- 1) Allowable loads are determined by roller–rail contact surface wheel load and bearing bending strength. Use rails with SS400 or stronger material. Do not use bearing rollers with curved rails.
- 2) For lubed specifications, lack of lubrication will cause poor rotation. Use non-lubed or water resistant specifications in environments where the chain may come into contact with water.
- 3) Do not use in acidic or alkaline environments. Water resistant specifications (SUS400 Series parts) may rust in certain usage environments.
- 4) Poor rail installation, sprocket misalignment, or other equipment side operating conditions will cause an excessive thrust load to act on the chain in the direction of roller rotation. Adjust rails and sprockets to avoid this issue.

# For Safe Use



## Warning

Observe the following points to prevent hazardous situations.

- Do not use chains or accessories (peripheral devices and parts) for anything other than their original purpose.
- Never perform additional work on the chain.
  - Do not anneal the various parts of the chain.
  - Do not clean the chain with acids or alkalis, as they may cause cracking.
  - Never electroplate the chain or its parts, as this may cause cracking due to hydrogen embrittlement.
  - Do not weld the chain, as the heat may cause cracking or a reduction in strength.
  - When heating or cutting the chain with a torch, remove the links immediately adjacent and do not use them again.
- When there is a need to replace a damaged (fractured) portion of a chain, always replace the whole chain with a new product rather than replacing only the damaged or fractured portion.
- When using a chain and sprocket on suspension equipment, establish a safety fence and strictly prevent entry to the area directly below the suspended object.
- Always install hazard protection devices (safety covers, etc.) for the chain and sprocket.
- Immediately stop using the chain if it comes into contact with a substance that can cause embrittlement cracking (acid, strong alkali, battery fluid, etc.) and replace with a new chain.
- When installing, removing, inspecting, maintaining, and lubricating the chain:
  - Perform the work according to the instruction manual or this catalog.
  - Always turn off the power switch to the equipment beforehand and make sure that it cannot be turned on accidentally.
  - Secure the chain and sprocket so that they cannot move freely.
  - Use a press or other special tool to cut and connect chain, and cut and connect using the proper procedures.
  - Wear clothing and protective gear (safety glasses, gloves, safety shoes, etc.) that are appropriate for the work.
  - Only experienced personnel should replace chains and sprockets.
- Install hazard protection devices (safety equipment, etc.) on suspension equipment using Leaf Chain to prevent hazard or injury in the event of chain failure.
- Install protection equipment for safety on the equipment side when using chain on personnel transport devices or lifting equipment.



## Caution

Observe the following points to prevent accidents.

- Only handle chains and sprockets after thoroughly understanding their structure and specifications.
- When installing chains and sprockets, inspect them in advance to confirm that they have not been damaged in transport.
- Always regularly inspect and maintain your chains and sprockets.
- Chain strength varies according to manufacturer. When selecting a chain based on a Tsubaki catalog always use the corresponding Tsubaki product.
- Minimum tensile strength refers to the failure point when a load is applied to the chain once and does not refer to the allowable operational load.
- Lubricate connecting links (CL/OL) before assembling onto the base chain.
- Always ensure that the final customer receives the instruction manual.
  - If you do not have the instruction manual, contact a Tsubaki representative with the product name, series name, and chain/model number to receive the appropriate manual.
- The product information given in this catalog is mainly for selection purposes. Thoroughly read the instruction manual before actually using this product, and use the product properly.

## Warranty

### 1. Warranty Period

Products manufactured by Tsubakimoto Chain Co. ("Products") are warranted against defects in materials and workmanship for eighteen (18) months from the date of shipment from the factory or twelve (12) months from the date the Products are first placed into operation (calculated from the date the Products have been installed on the customer's equipment), whichever comes first.

### 2. Scope of Warranty

During the warranty period, if defects arise in the Products when installed, used, and maintained correctly in accordance to Tsubakimoto Chain's catalogs, installation manuals (including any documents specially prepared and provided to the customer) and the like, Tsubakimoto Chain will repair or replace such defective Products thereof free of charge upon confirmation of said defect by Tsubakimoto Chain. This warranty shall only apply to Products received, and Tsubakimoto Chain shall not be liable for the following costs and/or damages (including installation manuals or other documents specially prepared and provided to the customer):

- (1) Costs required for removing the defective Products from or re-installing the replacement Products on the customer's equipment for replacement or repair of the defective Product, as well as any associated installation costs.
- (2) Costs required to transport the customer's equipment, if needed, to a repair shop or the like.
- (3) Any consequential or indirect damages or loss of profits or benefits the customer may incur due to the defects or repair of the Products.

### 3. Out of Warranty Service and Repair

Regardless of the warranty period, Tsubakimoto Chain will provide investigation, repair, and/or manufacture of the Products for a fee should the Products experience problems or anomalies under the following situations.

- (1) Placement, installation (including connecting and disconnecting), lubrication, or maintenance of the Products not in accordance with Tsubakimoto Chain's catalogs, installation manuals (including documents specially prepared and provided to the customer), or the like.
- (2) Use of the Products (including operating conditions, environment, and allowances) not in accordance with Tsubakimoto Chain's catalogs, installation manuals (including documents specially prepared and provided to the customer), or the like.
- (3) Inappropriate disassembly, modification, or processing of the Products by the customer.
- (4) Use of the Products with damaged or worn products. (Example: Use of the Products with a worn sprocket, drum, rail, or the like.)
- (5) When the operating conditions exceed the performance of the Products as selected using the Tsubakimoto Chain selection method.
- (6) Use of the Products in conditions other than what have been discussed.
- (7) When consumables such as bearings, oil seals, and lubricant in the Products deplete, wear, or degrade.
- (8) When secondary damage occurs to the Products due to initial or primary damage or failure to the customer's equipment.
- (9) Damage or failure of the Products due to forces majeure such as natural disasters.
- (10) Damage or failure of the Products due to unlawful conduct by third parties.
- (11) Damage or failure of the Products due to causes not attributable to Tsubakimoto Chain

The logos, brand names, or product names in this catalog are trademarks or registered trademarks of Tsubakimoto Chain Co. in Japan and other countries.



## TSUBAKIMOTO CHAIN CO.

Japan Tsubakimoto Chain Co. <https://tsubakimoto.com/>

### Global Group Companies

#### AMERICAS

United States U.S. Tsubaki Power Transmission, LLC <https://www.ustsubaki.com/>  
Brazil Tsubaki Brasil Equipamentos Industriais Ltda. <https://tsubaki.ind.br/>  
Canada Tsubaki of Canada Limited <https://tsubaki.ca/>

#### EUROPE

Netherlands Tsubakimoto Europe B.V. <https://tsubaki.eu/>  
France Kabelschlepp France S.A.R.L. <https://tsubaki-kabelschlepp.com/fr-fr/>  
Germany Tsubaki Deutschland GmbH <https://tsubaki.de/>  
Tsubaki Kabelschlepp GmbH <https://tsubaki-kabelschlepp.com/de-de/>  
Italy Kabelschlepp Italia S.R.L. <https://tsubaki-kabelschlepp.com/it-it/>  
Spain Tsubaki Ibérica Power Transmission S.L. <https://tsubaki.es/>  
United Kingdom Tsubakimoto UK Ltd. <https://tsubaki.eu/>  
Slovakia Kabelschlepp-Systemtechnik, spol. s.r.o. <https://tsubaki-kabelschlepp.com/sk-sk/>  
Poland Kabelschlepp Sp. z o.o. <https://kabelschlepp.pl/>

#### INDIAN OCEAN RIM

Singapore Tsubakimoto Singapore Pte. Ltd. <https://tsubaki.sg/>  
Australia Tsubaki Australia Pty. Limited <https://tsubaki.com.au/>  
India Tsubaki India Power Transmission Private Limited <https://en.tsubaki.in/>  
Indonesia PT. Tsubaki Indonesia Trading <https://tsubaki.id/>  
Malaysia Tsubaki Power Transmission (Malaysia) Sdn. Bhd. <https://en.tsubaki.my/>  
New Zealand Tsubaki Australia Pty. Limited - New Zealand Branch <https://tsubaki.com.au/>  
Philippines Tsubakimoto Philippines Corporation <https://en.tsubaki.ph/>  
Thailand Tsubakimoto (Thailand) Co., Ltd. <https://tsubaki.co.th/>  
Vietnam Tsubakimoto Vietnam Co., Ltd. <https://tsubaki.net.vn/>

#### EAST ASIA

Republic of Korea Tsubakimoto Korea Co., Ltd. <https://tsubakimoto-tck.co.kr/>  
Taiwan Taiwan Tsubakimoto Trading Co., Ltd. <https://tsubakimoto.tw/>

#### CHINA

China Tsubakimoto Chain (Shanghai) Co., Ltd. <https://www.tsubaki-sh.cn/>



The Tsubaki Eco Link logo is used only on products that satisfy the standards for environmental friendliness set by the Tsubaki Group.